

TURBO 160

ELECTROMECHANICAL IRREVERSIBLE GEAR MOTOR FOR SLIDING GATES UP TO 1600 Kg, 230 Vac



PLUS

With slowdown function in both opening and closing to preserve your gate integrity

Electronic and mechanical parts well protected from external agents

Easy maintenance thanks to the horizontal control unit position

One control unit suitable for all 230 Vac motors

With fixing plate included

Compatible with new 230Vac control unit CT102, (pag. 108 for technical details)

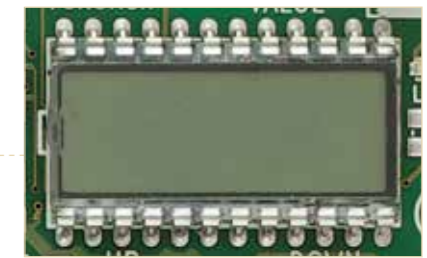
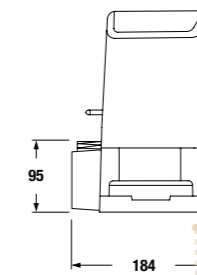
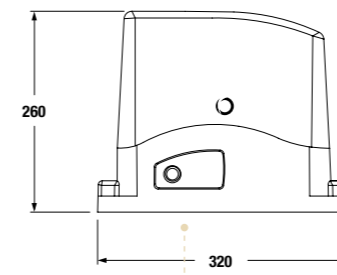

LCD display for immediate interface



Sturdy and performing motors



Bronze internal gear

CODE	DESCRIPTION	PCS PALLET
SC-100	230 Vac motor, without control unit, with mechanic limit switch, for gates up to 1600 kg	36
SC162 ¹	230 Vac motor, control unit with slowdown, mechanic limit switch, for gates up to 1600 kg. With connectors for receiver	36
SC162M ²	M230 Vac motor, control unit with slowdown, magnetic limit switch, for gates up to 1600 kg. With connectors for receiver	36

upon stock termination of old codes ¹ SC-101CS, ² SC-101CSM

TECHNICAL DATA		SC-100	SC162 SC162M
control unit		-	CT102
power	Vac (Vdc)	230	230
consumption power	W	700	700
motor consumption	A	3	3
capacitor	µF	20	20
protection degree	IP	44	44
torque	Nm	40	40
speed*	cm/s	16	16
thrust force	N	1000	1000
max gate weight	kg	1600	1600
thermoprotection	°C	150°	150°
insulation class		1	1
working cycle	%	30	30
working temperature	°C	-20° + 55°	-20° + 55°
weight	kg	13,5	13,5

* Variable data according to gate weight

ACCESSORIES



CPHSC-50
Rised fixing plate



CREM-12
M4 iron toothed rack
30x12 mm L=1000 mm



TS
Warning board