

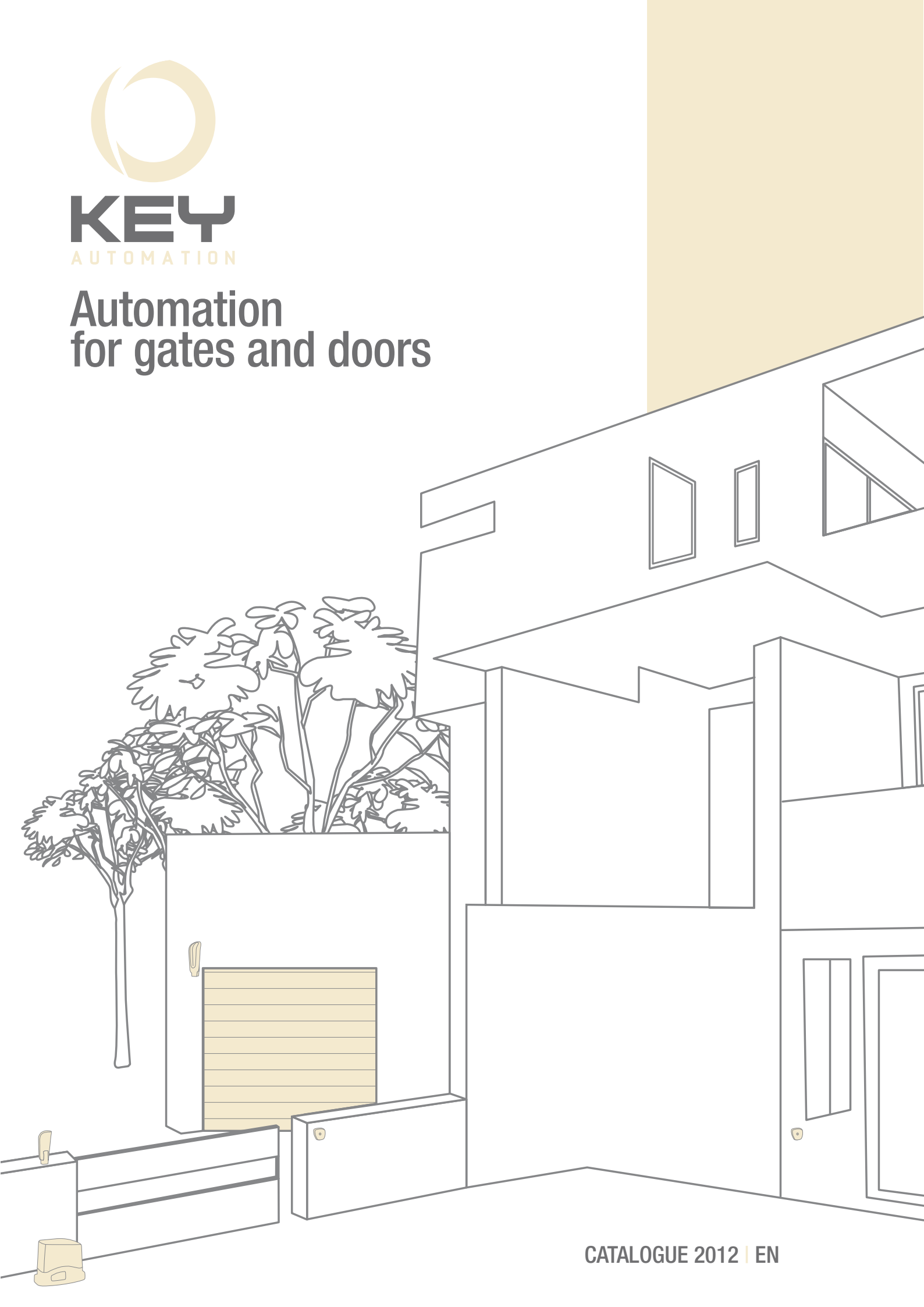

KEY
AUTOMATION

Automation for gates and doors





Under a new light.

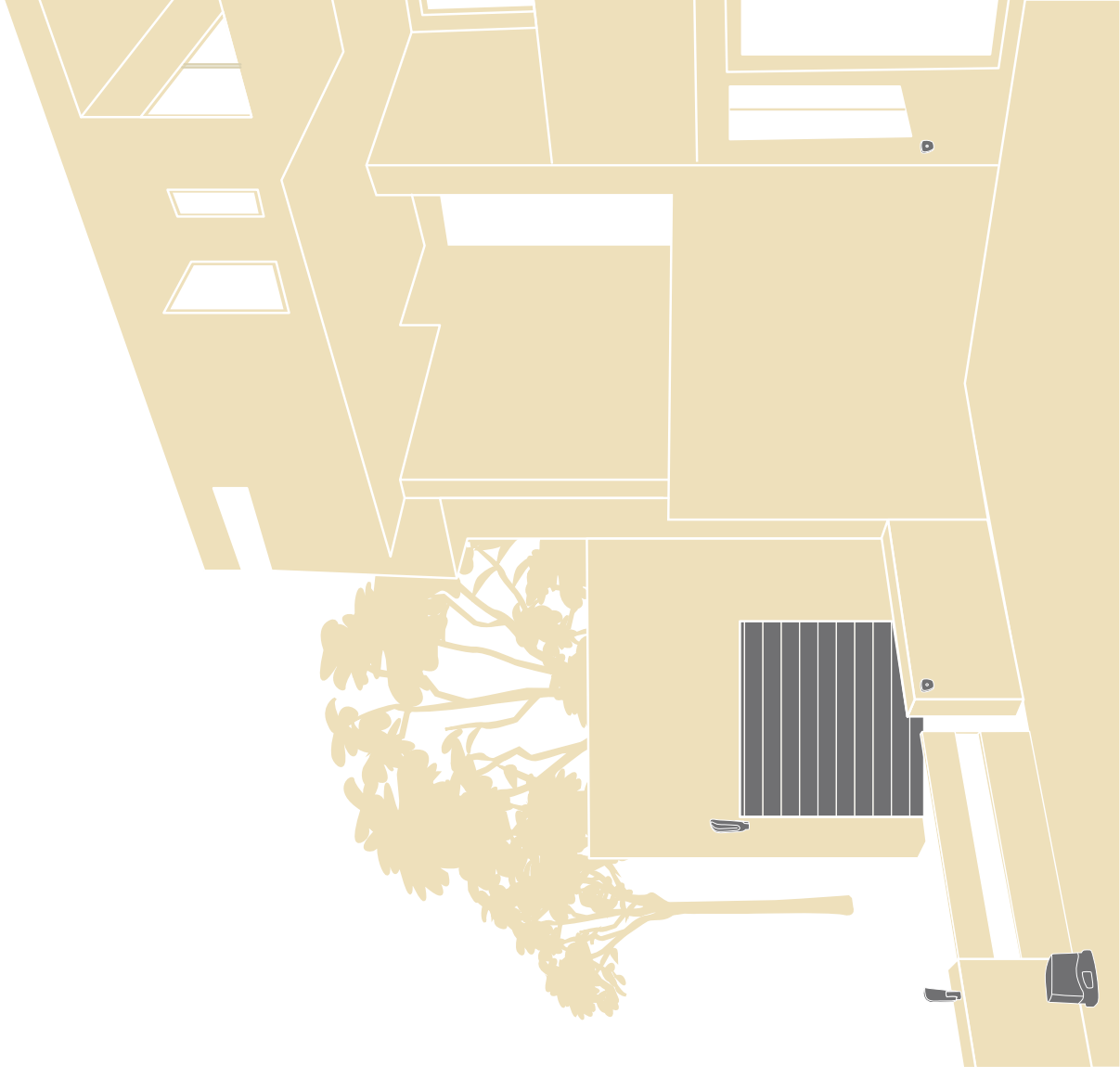

KEYStyle



A new way to conceive style and design is born, applying high technological working processes to tidy materials with extreme attention and care for details. The effect disclose great beauty and strong impact. The result is a product line characterized by a unique shape and design, whose goal is not only comfort and utility, but also improving value to its installation context by exalting and bringing out the location around it. Aesthetic research conceived not against functionality and robustness. Our new Keystyle is pure Italian design applied to Italian technology: a synergy of combining forces, just the beginning of a development plan of our new design research project.



Turbo
Compact body with sinuous rounded shape. Smooth and harmonious lines. New bright colors, suitable in all setting.



Star
Appropriate design for all installation. Elegance, force and toughness. Products not only appreciated for their technical features.



Mewa
Excellent surface finishing thanks to the sanding treatment realized on die casting mould. Power and force expressed by the reinforced structure and arm.



Alt
Stylish round shape cover and built-in LED flashing light. Anti-UV epoxy powder coating with orange-peel finishing which can resist to the hardest weather conditions.



Viper
Sinuous design. Bicolor and bimaterial. Very wide courtesy light. Silent and fast.

KEY Technology

Key automation enters a new phase where technology is not just applied on mechanical concepts, but also on design.

A detailed study of design and materials application has started with the upcoming creation of unique and recognizable products. The first example is SUB, the new 4 channels water resistant transmitter, the perfect application of the most advanced technologies on materials use and technological processes.

A sophisticated molding process named tri-injection process enables the use of three different materials in the same working cycle. A shiny transparent PMMA surface, scratch resistant, wear resistant, stain resistant and shockproof. A screen to protect the inner colored surface from staining and color fading over time. Under such transparent film, ABS colored surface, available in many different tones, presenting long lasting durability and inner logo printing. The buttons rubber avoid breaks, spots, wear and plastic retention due to heat and humidity.

1. Sub mold
2. Sub mold during molding phase
3. Sub mold detail

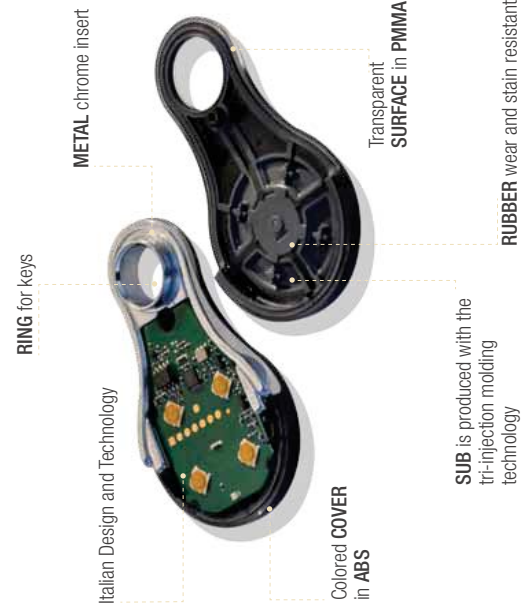

+ DESIGN
Aluminum body with powder coating to resist to the hardest atmospheric agents. Smooth design conceived not in spite of force and robustness.



+ TECHNOLOGY
High technology solutions. Mechanical and electronic parts well protected from external agents. Large use of sturdy materials such as bronze, steel and aluminum worked through high precision mechanical processes.



KEY Electronics

Electronic conceived internally by an high specialized team of expert engineers. Know-how developed and strengthened after many years of experience in the sector. A creation of a new range of products with advanced performance easy to program and use at the same time. Standard and intuitive language settings.



24 Vdc



230 Vac



400 Vac



Energy saving, solar panels integration



Possibility to integrate batteries



LCD Display



Encoder

NEW

A new generation self-programming 24Vdc control unit named CT-724S for sliding, overhead motors and electromechanical barriers. CT-724S is provided with safety and LED command indication. Easy configuration with LCD display with fast menu for rapid installations or more advanced menu for very customized installations. Flashing light, courtesy light and open gate light exits can be set up separately. All electronic components are well protected from short-circuit and overcharge.



NEW



230Vac rolling code control unit for rolling shutters motors inside plastic box. With electronic clutch and built-in radio receiver. Self learning possibility via radio. CT-1EBR manages the limit switch, safety stop and photocells. Flashing light exit and open gate light are present to fulfill the installation comfort.

NEW



2 channels universal receiver named RXM-22, with possibility to set either fix or rolling code mode. Available in a practical and compact plastic box.

telectronics

KEY Gates, & KEY Doors & KEY Accessories

Key Gates

10

Systems for swing gates

12

Systems for sliding gates

32

Electromechanical barriers and rising bollards

52



Key Doors

64

Systems for rolling shutters

66

Systems for industrial doors

76

Systems for overhead and sectional doors

80

Automation for sliding doors

90



Key Accessories

108

Control units and programmable functions

110

Accessories

116



KEY Gates

Systems for swing gates

Star 200	18
Star 300	20
Star 500	22
Mewa 2	24
Mewa	26
Under	28
Kit 24 Vdc	30
Kit 230 Vac	31

Systems for sliding gates

Turbo 30	36
Turbo 50	38
Turbo 80	40
Turbo 120	42
Turbo 160	44
Turbo 250	46
Turbo 400	48
Turbo Kit	50

Electromechanical barriers

Alt 4KP / 6KP	56
Alt 4 / 4P / 6 / 6P	58
Alt 4KP / 6KP / 4 / 4P / 6 / 6P Common accessories	60
City	62

SYSTEMS FOR SWING GATES

User manual

keyhome

STAR 200 WITH LEAVES UP TO 2 m STAR KIT	intensive use	PS-200
STAR 300 WITH LEAVES UP TO 3 m STAR KIT	normal use	PS-300FA
	intensive use	PS-300FA-R PS300-24FA
STAR 500 WITH LEAVES UP TO 5 m STAR KIT	normal use	PS-400FA
	intensive use	PS-400FA-R PS400-24FA
MEWA 2 GEAR MOTOR WITH ARTICULATED ARMS FOR SWING GATES WITH LEAVES UP TO 2 m MEWA KIT 2	intensive use	SN-21
	normal use	SN-21CS SN-50
MEWA GEAR MOTOR WITH ARTICULATED ARMS FOR SWING GATES WITH LEAVES UP TO 4 m MEWA KIT	intensive use	SN-50-24
	normal use	INT
UNDER UNDERGROUND GEAR MOTOR FOR SWING GATES WITH LEAVES UP TO 3 m UNDER KIT	normal use	INT10
	normal use	INT-24



KEY Installations

STAR200
STAR300
STAR500

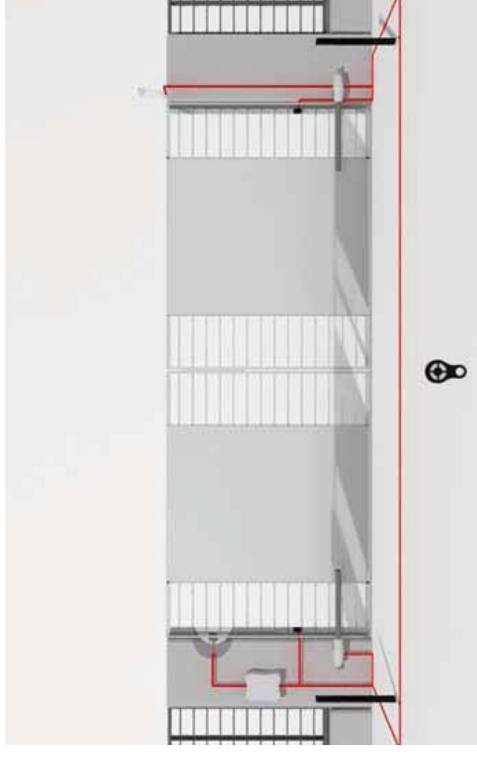

MEWA2



KEY Installations

MEWA

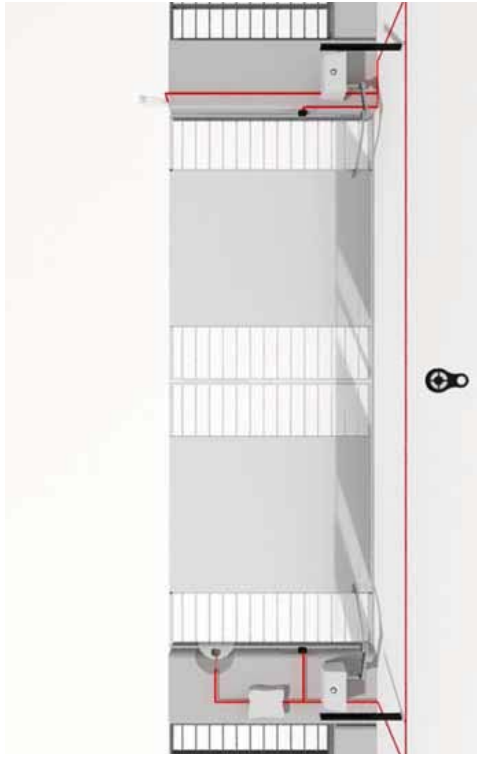

UNDER



STAR 200

PLUS

Encoder available for maximum safety in the obstacle detection.

Easy slowdown and open limit settings.

Mechanical parts well protected from external agents.

Available on kit version with new CT-824S control unit.

New generation control unit with LCD display.

With soft start and soft stop function availability.

Motor speed regulation and safety edge connection possibility.

ELECTROMECHANICAL IRREVERSIBLE GEAR MOTOR FOR SWING GATES WITH LEAVES UP TO 2 m, 24 Vdc

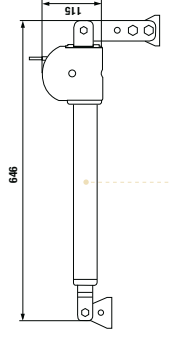

Sturdy telescopic stem.

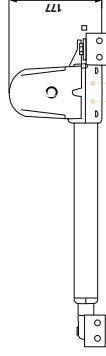

Robust gears and mechanical parts.



Metallic release system.



ACCESSORIES



ELS-0
Horizontal 12 V electrolock



ELS-V
Vertical 12 V electrolock

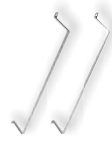

KITFIXBATT
Kit fixing batteries 24 V (2 pcs).



BAT-12-2A
Battery 12 V 2 A.



TS
Warning board.

TECHNICAL DATA		LIMITS USE	
control unit	PS-200 CT-824S*	<p>Max gate length (m)</p> <p>Max gate weight (kg)</p> <p>Gates shape and height depend on the weight. They can considerably reduce the values shown above, in the graph. 230 Vdc motors are suggested for windy areas.</p>	
power	Vac 24		
consumption power	W 120		
motor consumption	A 5		
protection degree	IP 54		
thrust force	N 1400		
working cycle	% 80		
shutter opening	Max 90° / 120°		
opening time at 90°	sec 20		
working temperature	°C -20° + 55°		
weight	kg/cad 8,6		

* Suggested control unit.

STAR 300

PLUS

Opening mechanical limit switch, to control your gate movement.

Encoder available in the 24 Vdc version for the obstacle detection.

Double bearing on the main screw to grant robustness and movement fluidity.

Possibility of battery integration in the 24 Vdc version.

Easy mechanical release.

Mechanical parts well protected from external agents.

Available on kit version with new CT-824S control unit.

New generation control unit with LCD display.

With soft start and soft stop function availability.

Motor speed regulation and safety edge connection possibility.

ELECTROMECHANICAL GEAR MOTOR FOR SWING GATES WITH LEAVES UP TO 3 m, 24 Vdc AND 230 Vac

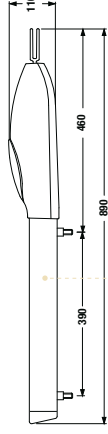

Double bearing on the main screw to grant robustness and movement fluidity.

Easy mechanical release.

Robust bronze lock nut on endless screw.



ACCESSORIES

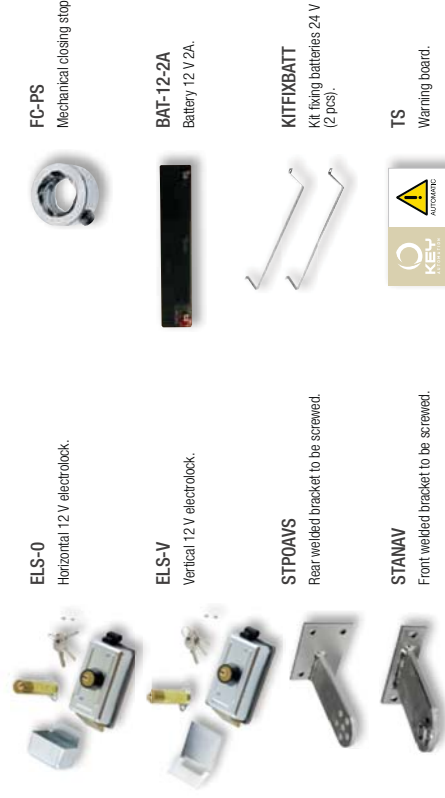

ELS-0
Horizontal 12 V electrolock.

FC-PS
Mechanical closing stop.

ELS-V
Vertical 12 V electrolock.

BAT-12-2A
Battery 12 V 2A.

STPOAVS
Rear welded bracket to be screwed.

KITFIXBATT
Kit fixing batteries 24 V (2 pcs).

STANAV
Front welded bracket to be screwed.

TS
Warning board.

CODE	DESCRIPTION	PCS PALLET
PS-300FA	For leaves up to 3 m, irreversible 230 Vac motor, with mechanic opening limit switch (1 pc).	25
PS-300FA-R	For leaves, up to 3 m, reversible 230 Vdc motor, with mechanic opening limit switch (1 pc).	25
PS300-24FA	For leaves up to 3 m, irreversible 24 Vdc motor with encoder and mechanic opening limit switch (1 pc).	25

TECHNICAL DATA	PS-300FA		PS-300FA-R		PS300-24FA	
	CT-2 / CT-201*	CT-201*	CT-2 / CT-201*	CT-201*	CT-824S*	CT-824S*
power	Vac (Vdc)	230	230	230	(24)	(24)
consumption power	W	250	250	250	120	120
motor consumption	A	1,1	1,1	1,1	5	5
capacitor	µF	10	10	10	-	-
protection degree	IP	44	44	44	44	44
thrust force	N	1700	1300	1500	1500	1500
shutter opening	Max	90° / 120°	90° / 120°	90° / 120°	90° / 120°	90° / 120°
temporary service	%	30	30	30	80	80
thermo-protection	°C	150°	150°	150°	-	-
opening time at 90°	sec	23	19	19	20	20
working temperature	°C	-20° + 55°	-20° + 55°	-20° + 55°	-20° + 55°	-20° + 55°
weight	kg	8	8	8	8	8

LIMITS USE

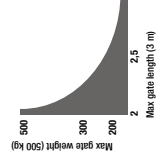

Gate's shape and height can considerably reduce the values shown above, in the graph. 230 Vdc motors are suggested for windy areas.

* Suggested control unit.

STAR 500

PLUS

Opening mechanical limit switch, to control your gate movement.

Encoder available in the 24 Vdc version for the obstacle detection.

Double bearing on the main screw to grant robustness and movement fluidity.

Possibility of battery integration in the 24 Vdc version.

Easy mechanical release.

Mechanical parts well protected from external agents.

Available on kit version with new CT-824S control unit.

New generation control unit with LCD display.

With soft start and soft stop function availability.

Motor speed regulation and safety edge connection possibility.

ELECTROMECHANICAL GEAR MOTOR FOR SWING GATES WITH LEAVES UP TO 5 m, 24 Vdc AND 230 Vac

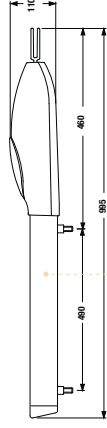

Double bearing on the main screw to grant robustness and movement fluidity.

Easy mechanical release.

Robust bronze lock nut on endless screw.



ACCESSORIES

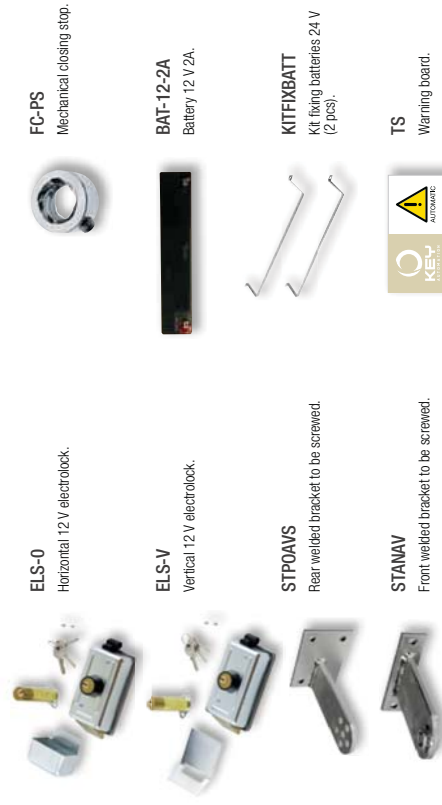

ELS-0
Horizontal 12 V electrolock.

ELS-V
Vertical 12 V electrolock.

STPOAVS
Rear welded bracket to be screwed.

STANAV
Front welded bracket to be screwed.



FC-PS
Mechanical closing stop.



BAT-12-2A
Battery 12 V 2A.



KITFIXBATT
Kit fixing batteries 24 V (2 pcs).



TS
Warning board.

CODE	DESCRIPTION	PCS PALLET
PS-400FA	For leaves up to 5 m, irreversible 230 Vac motor with opening limit switch (1 pc).	25
PS-400FA-R	For leaves up to 5 m, reversible 230 Vac motor with opening limit switch (1 pc).	25
PS-400-24FA	For leaves up to 5 m, irreversible 24 Vdc motor with encoder and opening limit switch (1 pc).	25



TECHNICAL DATA	PS-300FA		PS-300FA-R		PS300-24FA	
	CT-2 / CT-201*	230	CT-2 / CT-201*	230	CT-824S*	CT-824S*
power	Vac (Vdc)	230	230	230	(24)	(24)
consumption power	W	250	250	120	120	120
motor consumption	A	1,1	1,1	5	5	5
capacitor	µF	10	10	-	-	-
protection degree	IP	44	44	44	44	44
thrust force	N	1700	1300	1500	1500	1500
shutter opening	Max	90° / 120°	90° / 120°	90° / 120°	90° / 120°	90° / 120°
temporary service	%	30	30	80	80	80
thermo-protection	°C	150°	150°	150°	150°	150°
opening time at 90°	sec	23	24	25	25	25
working temperature	°C	-20° + 55°	-20° + 55°	-20° + 55°	-20° + 55°	-20° + 55°
weight	kg	8	9	8,5	8,5	8,5

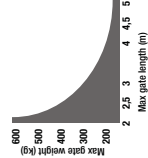

Gate's slope and height can considerably reduce the values shown above, in the graph. 230 Vac motors are suggested for windy areas.

* Suggested control unit.

MEWA 2

PLUS

With encoder, possibility of speed and slowdown regulation.

Max safety in the obstacle detection.

External release for an easy manual unlock from outside.

With slowdown, soft start and soft stop, to grant the product mechanical parts integrity.

Reinforced mechanical parts and structure.

CT-824S control unit:

New generation control unit with LCD display.

With soft start and soft stop function availability.

Motor speed regulation and safety edge connection possibility.

ELECTROMECHANICAL IRREVERSIBLE GEAR MOTOR WITH ARTICULATED ARM FOR SWING GATES WITH LEAVES UP TO 2 m, 24 Vdc



CODE	DESCRIPTION	PCS PALLET
SN-21	For leaves up to 2 m, 24Vdc motor, without control unit, with encoder, opening and closing electric limit switch and external release.	30
SN-21CS	For leaves up to 2 m, 24 Vdc motor, control unit with slowdown, encoder, opening and closing electric limit switch. With connectors for receiver.	30

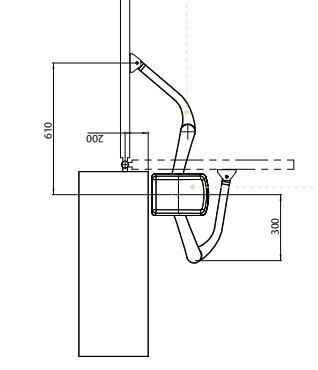
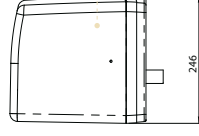
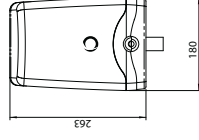

Electric limit switch.



Aluminum articulated arm with robust joining pin.



Robust mechanical components and gears.

ACCESSORIES



EELS-0
Horizontal 12 V electrolock.



EELS-V
Vertical 12 V electrolock.



KITFBSN20
Kit fixing batteries 24 V.



BAT-12-2A
Battery 12 V 2A.



TS
Warning board.

TECHNICAL DATA		SN-21	SN-21CS	SN-21CS	SN-21CS
control unit					CT-824S
power	Vdc	24	24	24	24
consumption power	W	120	120	120	120
motor consumption	A	5	5	5	5
protection degree	IP	63	63	63	63
thrust force	N	1200	1200	1200	1200
working cycle	%	80	80	80	80
shutter opening time	sec	15	15	15	15
working temperature	°C	-20° + 55°	-20° + 55°	-20° + 55°	-20° + 55°
weight	kg	12,5	14	14	14

LIMITS USE

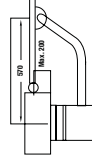
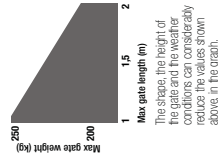

A max.	400
B max.	300
D max.	800

With encoder, possibility of speed and slowdown regulation. Max safety in the obstacle detection.

External release for an easy manual unlock from outside.

With slowdown, soft start and soft stop granting the product mechanical parts integrity.

CT-824S control unit.

New generation control unit with LCD display.

With soft start and soft stop function availability.

Motor speed regulation and safety edge connection possibility.

ELECTROMECHANICAL IRREVERSIBLE GEAR MOTOR WITH ARTICULATED ARM FOR SWING GATES WITH LEAVES UP TO 4 m, 24 Vdc AND 230 Vac

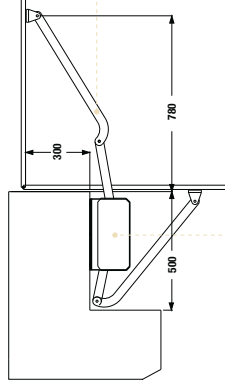
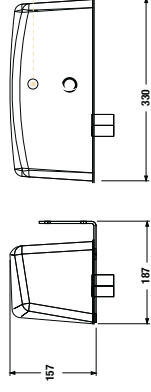

External release for an easy manual unlock from outside.



Reinforced and sturdy arm suitable for wide-angles opening.



Limit switch with high precision regulation.



CODE	DESCRIPTION	PCS PALLET
SN-50	For leaves up to 4 m, 230 Vac motor, with opening and closing electric limit switch.	36
SN-50-24	For leaves up to 4 m, 24 Vdc motor, with encoder.	36

TECHNICAL DATA	SN-50		SN-50-24		
	control unit	CT-2 / CT-201*	CT-824S*		
power	Vac (Vdc)	230	(24)		
consumption power	W	340	120		
motor consumption	A	1,5	5		
capacitor	µF	12	-		
protection degree	IP	43	43		
working cycle	%	30	80		
working temperature	°C	-20° + 55°	-20° + 55°		
weight	kg	14	13,8		
torque	Nm	400	350		

* Suggested control unit.

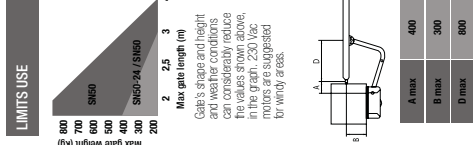

ACCESSORIES



ELS-0
Horizontal 12 V electrolock.

ELS-V
Vertical 12 V electrolock.

BMET
External metallic box for unlock, complete with start buttons.

KITFIXBATT
Kit fixing batteries 24 V (2 PCS).

SBLEXT
Cable release kit.

BAT-12-2A
Battery 12 V 2 A.

TS
Warning board.

UNDERGROUND ELECTROMECHANICAL IRREVERSIBLE GEAR MOTOR FOR SWING GATES WITH LEAVES UP TO 3 m, 24 Vdc AND 230 Vac

PLUS

With both opening and closing limit switch.

24 Vdc motor with encoder to provide big safety in the obstacle detection.

New cataphoresis housing box.

With the possibility of speed and slowdown regulation.

Possibility to choose between 1.5 m and 10 m cable motor.

CT-824S control unit:

New generation control unit with LCD display.

With soft start and soft stop function availability.

Motor speed regulation and safety edge connection possibility.



CODE	DESCRIPTION	PCS PALLET
INT	For leaves up to 3 m, 230 Vac motor, with opening and closing limit switch (1 pc). Cable length 1.5 m.	36
INT10	For leaves up to 3 m, 230 Vac motor, with opening and closing limit switch (1 pc). Cable length 10 m.	36
INT-24	For leaves up to 3 m, 24 Vdc motor, with encoder, opening and closing limit switch (1 pc).	36
CF	Cataphoresis housing box with connecting levers and mechanical stop.	36
CI	Stainless steel housing box, with connecting levers and mechanical stop (1 pc).	36
CFSB	Cataphoresis housing box with galvanized cover, without connecting levers.	36

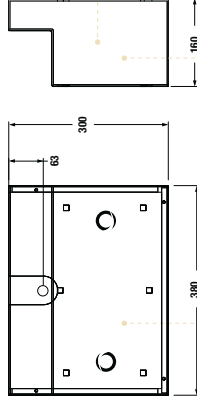

High precision limit switch.



Easy maintenance thanks to the double greasers both on housing and gear motor.



External and internal release by lever.



Bronze and tempered steel internal gears for maximum reliability over time.

TECHNICAL DATA	INT	INT-24
control unit	CF2 / CF201*	CF-824S*
power	Vac (Vdc) 230 (24)	
consumption power	W 230	120
motor consumption	A 1	5
capacitor	µF 10	-
protection degree	IP 67	67
torque	Nm 300	250
shutter opening	Max 108°	108°
working cycle	% 30	80
thermoprotection	°C 150°	-
opening time	sec 20	21
working temperature	°C -20° + 55°	-20° + 55°
weight	kg 11	10.8

* Suggested control unit.

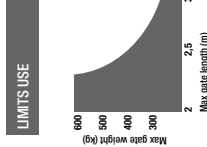

Gate's shape and height depend on the wind force. It can considerably reduce the values shown above in the graph. 230 Vac motors are suggested for windy areas.

ACCESSORIES



ELS-0
Horizontal 12 V electrolock.

ELS-V
Vertical 12 V electrolock.

AP110
Kit for over 110° opening.
For max 3000 mm long leaf.

KITFIXBATT
Kit fixing batteries 24 V
(2 PCS).

SBLINT
Connecting levers
with key.

BAT-12-2A
Battery 12 V 2 A.

TS
Warning board.



KIT 24 Vdc

FOR SWING GATES 24 Vdc

PLUS

With encoder for the obstacle detection.

Easy slowdown and open limit settings.

Mechanical parts well protected from external agents.

Opening mechanical limit switch to control your gate movement (KIT-PS324).

Double bearing on the main screw to grant robustness and movement fluidity (KIT-PS324).

NEW New water resistant SUB transmitter included.

NEW Aluminum key switch SEL-M included.

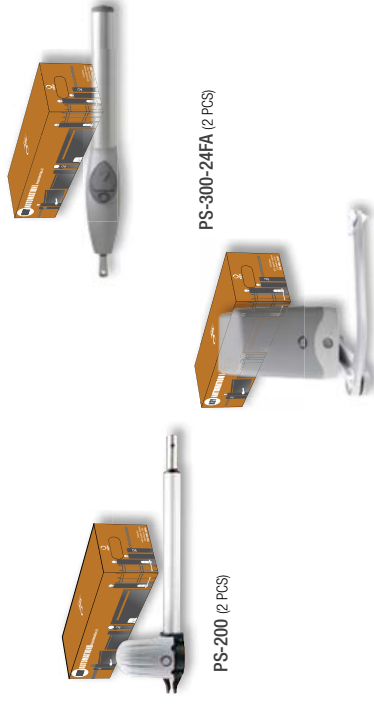

PS-200 (2 PCS)
PS-300-24FA (2 PCS)
SN-21 (1 PC)
SN-21CS (1 PC)

CODE	DESCRIPTION	PCS PALLET
(24V) KIT-PS200*	Kit for swing gates with leaves up to 2 m, 24 Vdc motor. Control unit with slowdown, encoder.	15
(24V) KIT-PS324*	Kit for swing gates with leaves up to 3 m, 24 Vdc motor. Control unit with slowdown and encoder and mechanic limit switch.	15
(24V) KITZ-433SN*	Kit for swing gates with leaves up to 2 m, 24 Vdc motor, with articulated arms. Control unit with slowdown, encoder and opening and closing electric limit switch.	15

* Kit available also in the rolling code version: KIT-PS200R, KIT-PS324R, KITZ433SNR.

KIT COMPONENTS



SEL-M

FT-31

CT-824S



LUMY-24



SUB-44W



RXI-22



TS

KIT 230 Vac

FOR SWING GATES 230 Vac

PLUS

Possibility of speed and slowdown regulation.

Double bearing on the main screw to grant robustness and movement fluidity (KIT-PS301).

External release for an easy manual unlock from outside (KITSN-51).

With both opening and closing limit switch (KIT-INT1).

NEW New water resistant SUB transmitter included.

NEW Aluminum key switch SEL-M included.

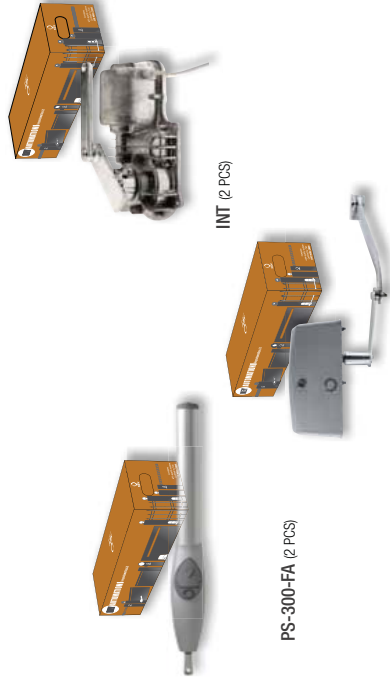

PS-300-FA (2 PCS)

INT (2 PCS)

SN-50 (2 PCS)

CODE	DESCRIPTION	PCS PALLET
KIT-PS301*	Kit for swing gates with leaves up to 3 m, 230 Vac motor. Control unit with slowdown and opening mechanic limit switch.	15
KITSN-51*	Kit for swing gates with leaves up to 4 m, 230 Vac motor, with articulated arms. Control unit with slowdown.	12
KIT-INT1* Housing boxes not included	Underground kit for swing gates with leaves up to 3 m, 230 Vac motor. Control unit with slowdown.	9

* Kit available also in the rolling code version: KIT-PS301R, KITSN-51R, KIT-INT1R.

KIT COMPONENTS



SEL-M

FT-31

CT-201



LUMY-230



SUB-44W



RXI-22



TS

SYSTEMS FOR SLIDING GATES

User manual

keyhome

TURBO 30 FOR GATES UP TO 300 kg TURBO KIT	— intensive use	— magnetic limit switch	— SC-30CSM
TURBO 50 FOR GATES UP TO 400 kg TURBO KIT	— intensive use	— magnetic limit switch	— SC-40-24
TURBO 50 FOR GATES UP TO 500 kg TURBO KIT	— normal use	— magnetic limit switch	— SC-40
		— magnetic limit switch	— SC-41CS
TURBO 80 FOR GATES UP TO 700 kg TURBO KIT	— intensive use	— magnetic limit switch	— SC-41CSM
		— magnetic limit switch	— SC-70-24
TURBO 80 FOR GATES UP TO 800 kg TURBO KIT	— normal use	— magnetic limit switch	— SC-50
		— magnetic limit switch	— SC-51CS
TURBO 120 FOR GATES UP TO 1100 kg TURBO KIT	— intensive use	— magnetic limit switch	— SC-51CSM
		— magnetic limit switch	— SC-71CS
TURBO 120 FOR GATES UP TO 1200 kg TURBO KIT	— normal use	— magnetic limit switch	— SC-110-24
		— magnetic limit switch	— SC-70
TURBO 160 FOR GATES UP TO 1600 kg TURBO KIT	— normal use	— magnetic limit switch	— SC-71CS
		— magnetic limit switch	— SC-71CSM
TURBO 160 FOR GATES UP TO 1600 kg TURBO KIT	— normal use	— mechanical limit switch	— SC-100
		— mechanical limit switch	— SC-101CS
TURBO 250 FOR GATES UP TO 2500 kg TURBO KIT	— normal use	— mechanical limit switch	— SC-101CSM
		— mechanical limit switch	— SC-200CS
TURBO 400 FOR GATES UP TO 4000 kg TURBO KIT	— normal use	— mechanical limit switch	— SC-240
		— mechanical limit switch	— SC-204CS
TURBO 400 FOR GATES UP TO 4000 kg TURBO KIT	— normal use	— mechanical limit switch	— SC-244
		— mechanical limit switch	— SC-400CS

keyindustry



KEY Installations

TURB050
TURB080
TURB0120
TURB0160

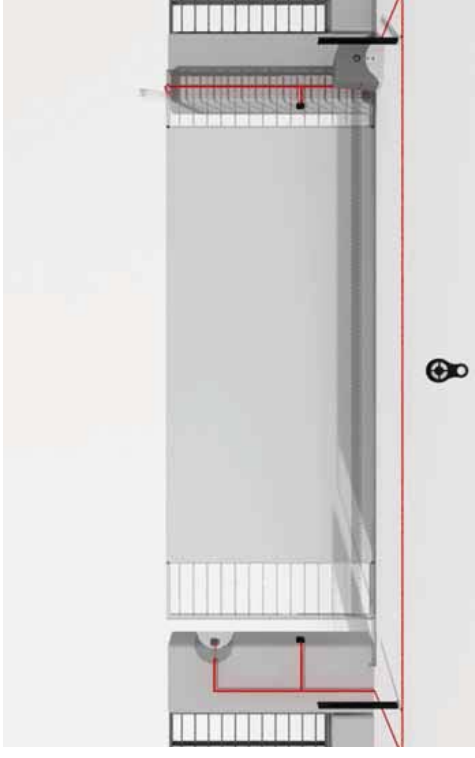

TURB0250

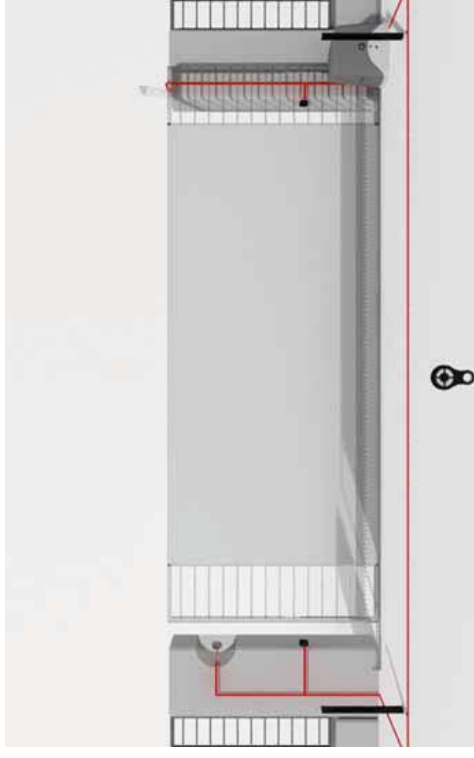

TURB0400

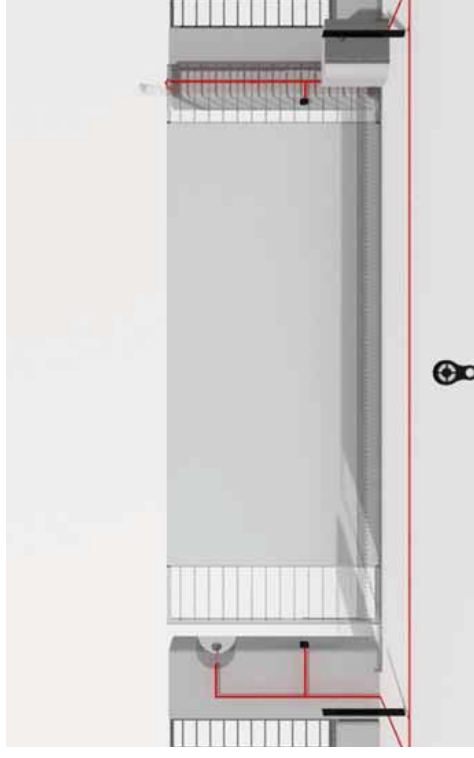

TURB030

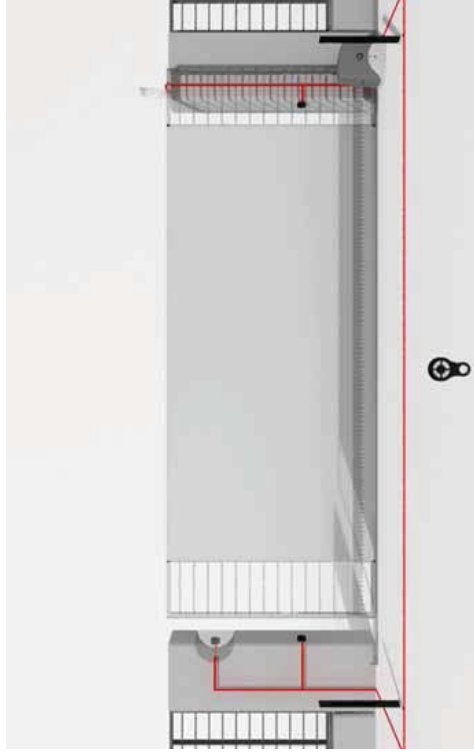

TURBO 30

PLUS

With slowdown function in both opening and closing to preserve your gate integrity.

Conceived to carry intensive use and harsh working conditions.

Electronic and mechanical parts well protected from external agents.

Easy maintenance thanks to the horizontal control unit position.

With magnetic encoder for detecting obstacles with maximum safety.

With fixing plate included.

ELECTROMECHANICAL GEAR MOTOR FOR SLIDING GATES UP TO 300 Kg, 24 Vdc

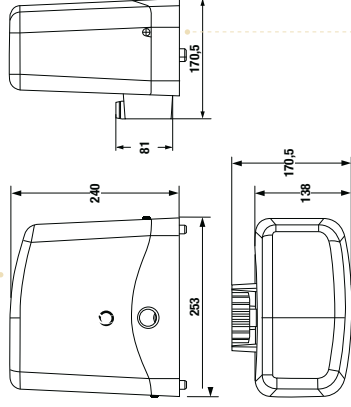

Internal battery back-up as optional.

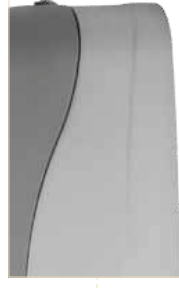

Hidden external case fixing.



Magnetic limit switch.

CODE	DESCRIPTION	P/S PALLET
SC-30CSM	24 Vdc motor, control unit with slowdown, encoder, magnetic limit switch, for gates up to 300 kg. With connectors for receiver. Intensive use.	36

TECHNICAL DATA

SC-30CSM	
control unit	CT-24M
power	Vac (Vdc) 230 (24)
consumption power	W 120
motor consumption	A 5
protection degree	IP 54
torque	Nm 10
speed	cm/s 20
thrust force	N 300
max gate weight	kg 300
insulation class	1
working cycle	% 80
working temperature	°C -20° + 55°
weight	kg 10,5

* Variable data according to gate weight.

ACCESSORIES



CREM-P

M4 nylon toothed rack
L= 1000 mm for gates
up to max 400 Kg.



CABAT-30M

Battery charger
for 24 Vdc motors.



BAT-12

Battery 12V 1.2A.



TS

Warning board.

TURBO 50

PLUS

With slowdown function in both opening and closing to preserve your gate integrity.

Electronic and mechanical parts well protected from external agents.

Easy maintenance thanks to the horizontal control unit position.

With magnetic encoder for detecting obstacles with maximum safety.

One control unit suitable for all 230 Vac motors.

With fixing plate included.

NEW New 24 Vdc motor, intensive use, for gates up to 400 kg.

NEW CT-724S self-programming control unit for 1 motor 24 Vdc.

Provided with safety and LED command indication.

Easy configuration with LCD display with 2 programming levels: basic and advanced one.

Flashing light, courtesy light and gate open light exit can be set up separately.

Electronic protection to motor short-circuit, with rapid intervention.

Overcharge protection.

Energy saving modality.

Self diagnosis through flashing light and display.

New generation Ni-MH batteries as optional on board.

ELECTROMECHANICAL IRREVERSIBLE GEAR MOTOR FOR SLIDING GATES UP TO 400 Kg FOR 24 Vdc, 500 Kg FOR 230 Vac



CODE	DESCRIPTION	PCS PALLET
SC-40	230 Vac motor, without control unit, with mechanic limit switch, for gates up to 500 kg.	36
SC-41CS	230 Vac motor, control unit with slowdown, encoder, mechanic limit switch, for gates up to 500 kg. With connectors for receiver.	36
SC-41CSM	230 Vac motor, control unit with slowdown, encoder, magnetic limit switch, for gates up to 500 kg. With connectors for receiver.	36
SC-40-24	24 Vdc motor, control unit with slowdown, encoder, mechanic limit switch, for gates up to 400 kg. With connectors for receiver, intensive use.	36



TECHNICAL DATA	SC-40	SC-41CS SC-41CSM	SC-40-24 CT-724S
control unit	-	CT-101	CT-724S
power	Vac (Vdc)	230	230
consumption power	W	300	300
motor consumption	A	1,3	1,3
capacitor	µF	12,5	12,5
protection degree	IP	44	44
torque	Nm	16	16
speed*	cm/s	16	30
thrust force	N	400	400
max gate weight	kg	500	500
thermoprotection	°C	150°	150°
insulation class		1	1
working cycle	%	30	30
working temperature	°C	-20°+55°	-20°+55°
weight	kg	12	12

* Variable data according to gate weight.



Internal battery back-up as optional.



Sturdy and performing motors.



High quality ball bearing.

ACCESSORIES

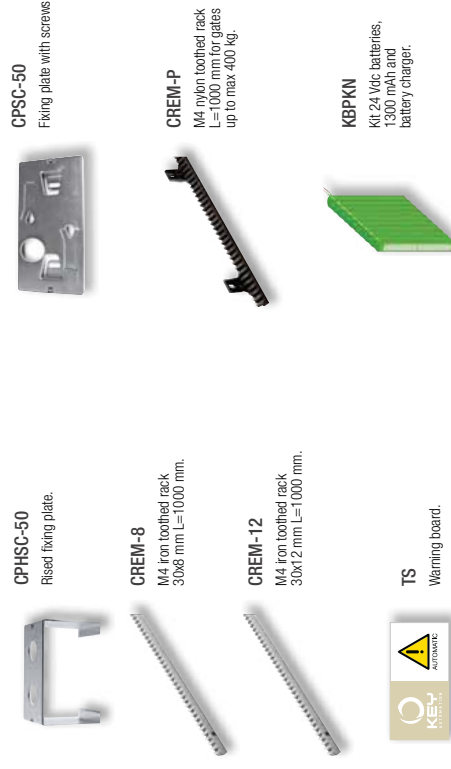

TURBO 80

PLUS

With slowdown function in both opening and closing to preserve your gate integrity.

Conceived to carry intensive use and harsh working conditions (SC-71CSI and SC-70-24).

Electronic and mechanical parts well protected from external agents.

Easy maintenance thanks to the horizontal control unit position.

With magnetic encoder for detecting obstacles with maximum safety.

One control unit suitable for all 230 Vac motors.

With fixing plate included.

NEW New 24 Vdc motor, intensive use, for gates up to 700 kg.

NEW CT-724S, new self-programming control unit for 1 motor 24 Vdc.

Provided with safety and LED command indication.

Easy configuration with LCD display with 2 programming levels: basic and advanced one.

Flashing light, courtesy light and gate open light exit can be set up separately.

Electronic protection to motor short-circuit, with rapid intervention.

Overcharge protection.

Energy saving modality.

Self diagnosis through flashing light and display.

New generation Ni-MH batteries as optional on board.

ELECTROMECHANICAL IRREVERSIBLE GEAR MOTOR FOR SLIDING GATES UP TO 700 Kg FOR 24 Vdc, 800 Kg FOR 230 Vac



CODE	DESCRIPTION	PCS PALLET
SC-50	230 Vac motor, without control unit, with mechanic limit switch, for gates up to 800 kg.	36
SC-51CS	230 Vac motor, control unit with slowdown, encoder, mechanic limit switch, for gates up to 800 kg. With connectors for receiver.	36
SC-51CSM	230 Vac motor, control unit with slowdown, encoder, magnetic limit switch, for gates up to 800 kg. With connectors for receiver.	36
SC-71CS	230 Vac motor, control unit with slowdown, encoder, mechanic limit switch, for gates up to 800 kg. With connectors for receiver. Intensive use.	36
24V SC-70-24	24 Vdc motor, control unit with slowdown, encoder, mechanical limit switch, for gates up to 700 kg. With connectors for receiver. Intensive use.	36

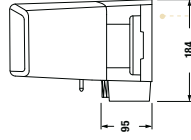
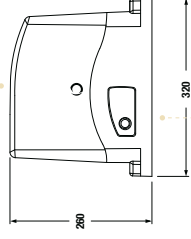

Internal battery back-up as optional.



Sturdy and performing motors.



High quality ball bearing.

ACCESSORIES



CPHSC-50
Raised fixing plate.



CREM-8
M4 iron toothed rack
30x8 mm L=1000 mm.



CREM-12
Cremagliera M4 in ferro
30x12 mm L = 1000 mm.



TS
Warning board.



CPSC-50
Fixing plate with screws.

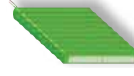

KBPKN
Kit 24 Vdc batteries,
1300 mAh and battery
charger, up to 500 kg.

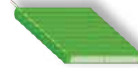

KBPKN2
Kit 24 Vdc batteries, 10
A, 1300 mAh and battery
charger, from 500 kg for
extreme performance.

TECHNICAL DATA	SC-50	SC-51CS SC-51CSM	SC-71CSI	SC-70-24
control unit	-	CT-101	CT-101	CT-724S
power	Vac (16c)	230	230	230 (24)
consumption power	W	450	450	350
motor consumption	A	1,9	1,9	2,5
capacitor	µF	16	16	12,5
protection degree	IP	44	44	44
torque	Nm	29	29	34
speed*	cm/s	16	16	30
thrust force	N	650	650	600
max gate weight	kg	800	800	700
thermoprotection	°C	150°	150°	-
insulation class		1	1	1
working cycle	%	30	30	60
working temperature	°C	-20° + 55°	-20° + 55°	-20° + 55°
weight	kg	12,5	12,5	13,5
				11

* Variable data according to gate weight

TURBO 120

PLUS

With slowdown function in both opening and closing to preserve your gate integrity.

Electronic and mechanical parts well protected from external agents.

Easy maintenance thanks to the horizontal control unit position.

With magnetic encoder for detecting obstacles with maximum safety.

One control unit suitable for all 230 Vac motors.

With fixing plate included.

NEW New 24 Vdc motor, intensive use, for gates up to 1100 Kg.

NEW CT-724S, New self-programming control unit for 1 motor 24 Vdc.

Provided with safety and LED command indication.

Easy configuration with LCD display with 2 programming levels: basic and advanced one.

Flashing light, courtesy light and gate open light ext can be set up separately.

Electronic protection to motor short-circuit, with rapid intervention.

Overcharge protection.

Energy saving modality.

Self diagnosis through flashing light and display.

New generation Ni-MH batteries as optional on board.

ELECTROMECHANICAL IRREVERSIBLE GEAR MOTOR FOR SLIDING GATES UP TO 1100 Kg FOR 24 Vdc, 1200 Kg FOR 230 Vac

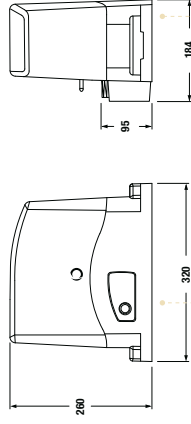

Magnetic encoder for a precise control of motor behaviour.



Sturdy and performing motors.



High quality ball bearing.



ACCESSORIES



CPHSC-50
Rised fixing plate.



CPSC-50
Fixing plate with screws.



CREM-8
M4 iron toothed rack
30x8 mm L=1000 mm.

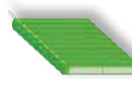

KBPKN2
Kit 24 Vdc batteries,
10 A, 1300 mAh and
battery charger, from 500 kg
for extreme performance.



CREM-12
M4 iron toothed rack
30x12 mm L=1000 mm.



TS
Warning board.

TECHNICAL DATA	SC-70		SC-71CS SC-71CSM		SC-110-24	
	CT-101	CT-724S	CT-101	CT-724S	CT-101	CT-724S
control unit						
power	Vdc (Vdc)	230	230	230 (24)		
consumption power	W	600	600	400		
motor consumption	A	2.6	2.6	2.3		
capacitor	µF	20	20			
protection degree	P	44	44	44		
torque	Nm	40	40	50		
speed*	cm/s	16	16	23		
thrust force	N	1000	1000	900		
max gate weight	kg	1200	1200	1100		
thermoprotection	°C	150°	150°	-		
insulation class		1	1	1		
working cycle	%	30	30	-		
working temperature	°C	-20° + 55°	-20° + 55°	-20° + 55°		
weight	kg	13.5	13.5	11		

* Variable data according to gate weight.

TURBO 160

PLUS

With slowdown function in both opening and closing to preserve your gate integrity.

Electronic and mechanical parts well protected from external agents.

Easy maintenance thanks to the horizontal control unit position.

With magnetic encoder for detecting obstacles with maximum safety.

One control unit suitable for all 230Vac motors.

With fixing plate included.

ELECTROMECHANICAL IRREVERSIBLE GEAR MOTOR FOR SLIDING GATES UP TO 1600 Kg, 230 Vac

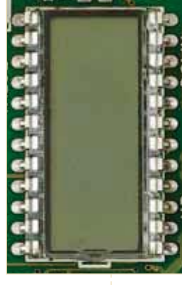
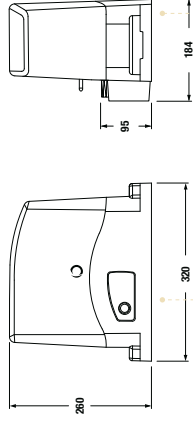

LCD display for immediate interface.



Sturdy and performing motors.



High quality ball bearing.



CODE	DESCRIPTION	PCS PALLET
SC-100	230 Vac motor, without control unit, with mechanic limit switch, for gates up to 1600 kg.	36
SC-101CS	230 Vac motor, control unit with slowdown, encoder, mechanic limit switch, for gates up to 1600 kg. With connectors for receiver.	36
SC-101GSM	M230 Vac motor, control unit with slowdown, encoder, magnetic limit switch, for gates up to 1600 kg. With connectors for receiver.	36

TECHNICAL DATA	SC-100		SC-101CS	SC-101GSM
			CF-101	
control unit				
power	Vac (Vdc)	230	230	
consumption power	W	700	700	
motor consumption	A	3	3	
capacitor	µF	20	20	
protection degree	IP	44	44	
torque	Nm	40	40	
speed*	cm/s	16	16	
thrust force	N	1000	1000	
max gate weight	kg	1600	1600	
thermo-protection	°C	150°	150°	
insulation class		1	1	
working cycle	%	30	30	
working temperature	°C	-20° + 55°	-20° + 55°	
weight	kg	13,5	13,5	

* Variable data according to gate weight.



ACCESSORIES



CPSC-50
Fixing plate with screws.



CPHSC-50
Rised fixing plate.



TS
Warning board.



CREM-12
M4 iron toothed rack
30x12 mm L=1000 mm.

TURBO 250

PLUS

With slowdown function in both opening and closing to preserve your gate integrity.

Electronic and mechanical parts well protected from external agents.

Easy maintenance thanks to the horizontal control unit position.

ELECTROMECHANICAL IRREVERSIBLE GEAR MOTOR FOR SLIDING GATES UP TO 2500 Kg, 230 AND 400 Vac



CODE	DESCRIPTION	PCS PALLET
SC-240	400 Vac motor, without control unit, with magnetic limit switch, for gates up to 2500 kg, M6 pignon.	16
SC-244	400 Vac motor, without control unit, with magnetic limit switch, for gates up to 2500 kg, M4 pignon.	16
SC-200CS	230 Vac motor, control unit with slowdown, with magnetic limit switch, for gates up to 2500 kg. With connectors for receiver, M6 pignon.	16
SC-204CS	230 Vac motor, control unit with slowdown, with magnetic limit switch, for gates up to 2500 kg. With connectors for receiver, M4 pignon.	16

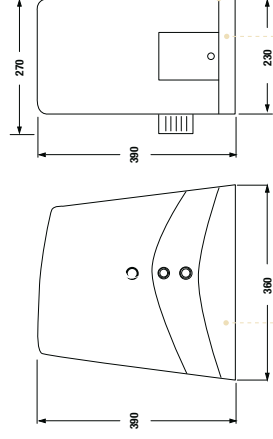

Hidden external case fixing.



Aluminum polished base and riser fixing plate.



Sturdy and performing motors.



LCD
015PLPH



ACCESSORIES



CREM-12
M4 iron toothed rack
30x12 mm L=1000 mm.



CREM-30
M6 iron toothed rack
30x30 mm L=1000 mm.



TS

Warning board.

TECHNICAL DATA	SC-240	SC-244	SC-200CS SC-204CS
control unit	CT-380 ***	CT-380 ***	CT-101
power	Vac (Vdc)	400	230
consumption power	W	650	580
motor consumption	A	1.5	1.5
capacitor	µF	-	35
protection degree	P	44	44
torque	Nm	63	57
speed**	cm/s	175	175
thrust force	N	1450	1300
max gate weight	kg	2500	2500
thermo-protection	°C	150°	150°
insulation class	F	F	1
working cycle	%	50	40
working temperature	°C	-20° + 55°	-20° + 55°
weight	kg	15,5	15,5
		15,5	16

* New color available while stocks last. ** Variable value according to gate weight. *** Suggested control unit.

TURBO 400

PLUS

With slowdown function in both opening and closing to preserve your gate integrity.

Electronic and mechanical parts well protected from external agents.

Easy maintenance thanks to the horizontal control unit position.

Electric brake, to grants safety also on heaviest installations.

For industrial installations.

ELECTROMECHANICAL IRREVERSIBLE GEAR MOTOR FOR SLIDING GATES UP TO 4000 Kg, 400 Vac

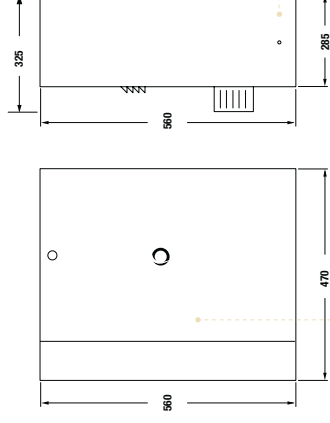

Sturdy and performing motor.



Anti-UV powder painting.

CODE	DESCRIPTION	P/S PALLET
SC-400GS	400 Vac motor, control unit with slowdown, magnetic limit switch, for gates up to 4000 kg. With connectors for receiver, M6 pignon.	4

TECHNICAL DATA

SC-400GS	
control unit	CT-380
power	Vac (Vdc) 400
consumption power	W 750
motor consumption	A 2
protection degree	IP 54
torque	Nm 180
speed*	cm/s 17
thrust force	N 3500
max gate weight	kg 4000
thermo protection	°C 150°
insulation class	1
working cycle	% 50
working temperature	°C -20° + 55°
weight	kg 76

* Variable data according to gate weight.



ACCESSORIES



CREM-30
M6 iron toothed rack
30x30 mm L=1 000 mm..



TS

Warning board.

TURBO KIT

FOR SLIDING GATES 24 Vdc

PLUS

With slowdown function in both opening and closing to preserve your gate integrity.

Electronic and mechanical parts well protected from external agents.

Easy maintenance thanks to the horizontal control unit position.

With magnetic encoder for detecting obstacles with maximum safety.

With fixing plate included.

Conceived to carry intensive use.

NEW New water resistant SUB transmitter included.

NEW New intensive use 24 Vdc kit, with new 24 Vdc control unit included.

NEW Aluminum key switch SEL-M, included.



CODE	DESCRIPTION	PCS PALLET
KT-433*	Kit for sliding gates up to 300 kg, 24 Vdc motor, control unit with slowdown, encoder, magnetic limit switch.	36
KSP4024	Kit for sliding gates up to 400 kg, 24 Vdc motor, control unit with slowdown, encoder, magnetic limit switch.	36
KSP7024	Kit for sliding gates up to 700 kg, 24 Vdc motor, control unit with slowdown, encoder, magnetic limit switch.	36
KSP11024	Kit for sliding gates up to 1100 kg, 24 Vdc motor, control unit with slowdown, encoder, magnetic limit switch.	36

* Kit available also in the rolling code version: **KT-433R, KSC4024R, KSC7024R, KSC11024R**

KIT COMPONENTS

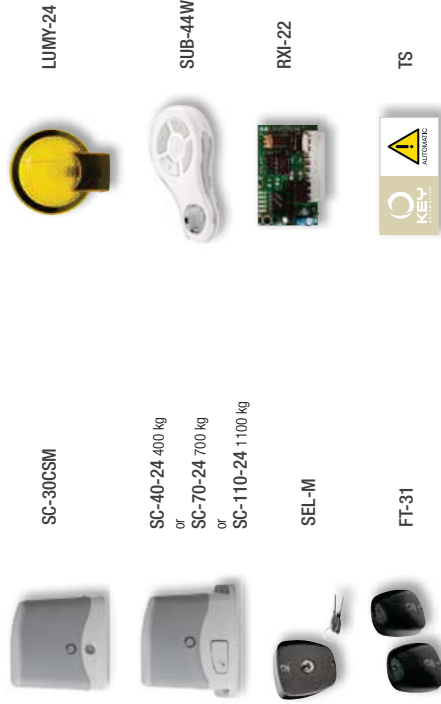

TURBO KIT

FOR SLIDING GATES 230 Vac

PLUS

With slowdown function in both opening and closing to preserve your gate integrity.

Electronic and mechanical parts well protected from external agents.

Easy maintenance thanks to the horizontal control unit position.

With magnetic encoder for detecting obstacles with maximum safety.

With fixing plate included.

NEW New water resistant SUB transmitter included.

NEW Aluminum key switch SEL-M, included.



CODE	DESCRIPTION	PCS PALLET
KT-433SL*	Kit for sliding gates up to 500 kg, 230 Vac motor, control unit with slowdown, encoder and magnetic limit switch.	36
KT-433SS*	Kit for sliding gates up to 800 kg, 230 Vac motor, control unit with slowdown, encoder and magnetic limit switch.	36
KT-SC71	Kit for sliding gates up to 1200 kg, 230 Vac motor, control unit with slowdown, encoder, magnetic limit switch.	36

* Kit available also in the rolling code version: **KT-433SLR, KT-433SSR, KITSC-71R**

KIT COMPONENTS



ELECTROMECHANICAL BARRIERS

User manual

keyindustry

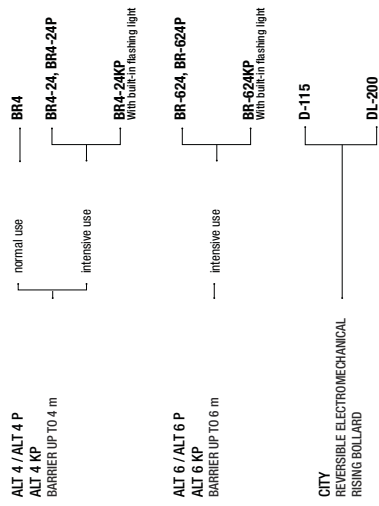

KEY Installations

ALT 4KP
ALT 6KP
ALT 4 / 4P
ALT 6 / 6P

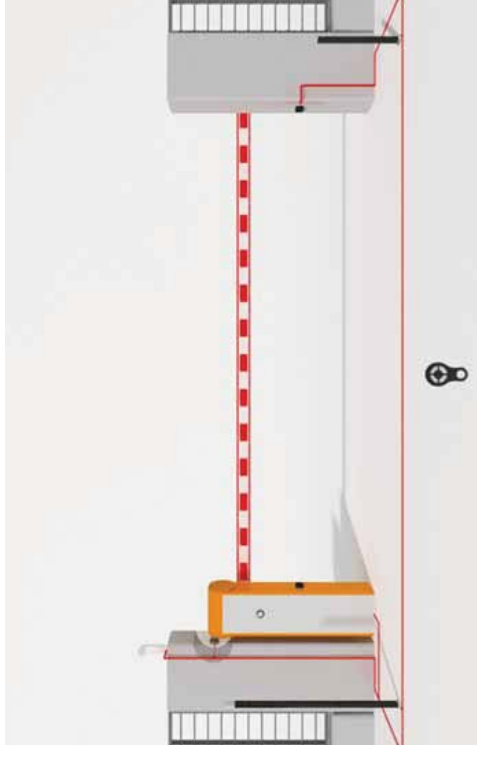

CITY

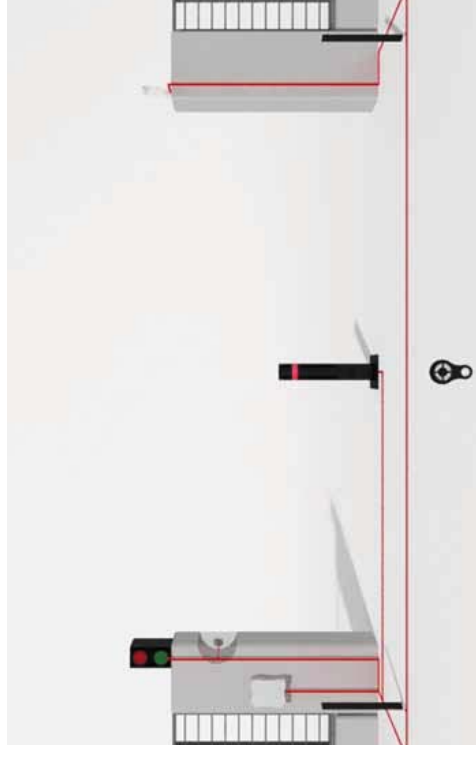

ALT 4KP. ALT 6KP

PLUS

On 6 m. model ALT has double spring to counter balance movement and make it more fluent, without bumps.

Anti-UV orange peel epoxy power coating.

Robust gears and levers for reliable functioning over time.



Application of new, 24 Vdc CT-724S control unit.

Performance increase: 3,5 sec opening time for 4m barrier and 6 sec for 6 m barrier.

Encoder for the obstacle detection and immediate run inversion.

Linear acceleration and deceleration to make opening and closing run as smooth as possible.

For an intensive use, for private and public solutions.

Energy saving modality in stand by.

Possibility to extract the control unit and program it in standing position for installer comfort and easy access.

Universal box: fast and easy installation of right or left bar depending on installation need.

ELETTROMECHANICAL IRREVERSIBLE BARRIER WITH DOUBLE BUILT-IN FLASHING LIGHT FOR BAR FROM 4 TO 6 m, 24 Vdc

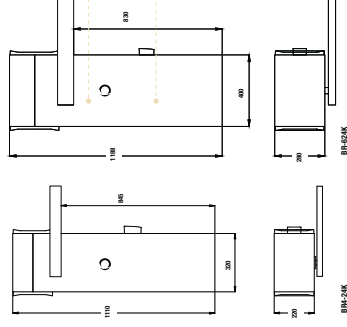
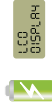

Metallic gear + shock resistant motor.



Double Led flashing light.

ACCESSORIES ALT 4KP ACCESSORIES ALT 6KP

CODE	DESCRIPTION	PCS PALLET
BR4-24KP	24 Vdc motor, with control unit in box, encoder, double built-in LED flashing light. Connector for receiver. For 4 m long barrier. Fast version.	6
BR-624KP	24 Vdc motor, with control unit in box, encoder, double built-in LED flashing light. Connector for receiver. For 6 m long barrier. Fast version.	5

TECHNICAL DATA	BR4-24KP		BR-624KP	
	CT-724S	CT-724S	CT-724S	CT-724S
control unit				
power	Vdc	24	24	24
consumption power	W	150	150	150
motor rpm	rpm	1200	1200	1200
motor consumption	A	6	6	6
capacitor	µF	-	-	-
opening time	sec	3.5	6	6
max bar length	m	4	6	6
working cycle	%	80	80	80
working temperature	°C	-20° + 55°	-20° + 55°	-20° + 55°
weight	kg	35	43	43
protection degree	IP	54	54	54



CP-BR
Anchorage plate with 4 rag bolts.



AS4
Aluminium bar L=4000 mm di. 60x30 mm.



AS-4J
2+2 m aluminium bar, 60x30x2 with joint included.



AST4
Aluminium tubular bar L=4000 mm Ø 60 mm, in case of strong wind.



ATAST60
Connection for round bar Ø 60 mm.



AS-SM03
Joint for articulated rods with 3 m aluminium bar included (only for ALT 4KP).



CP-BR6
Anchorage plate with 6 rag bolts.



AS6
Aluminium bar L=6000 mm di. 100 x 40 mm.



AS-6J
3+3 m aluminium bar, 100x40x2 with joint included.



AST6
Aluminium tubular bar L=6000 mm Ø 90 mm, in case of strong wind.

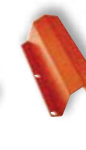

ATAT90
Connection for round bar Ø 90 mm.



PROF6
Flexible rubber profile, 12 m and plug set for AS6.



PROF
Flexible rubber profile, 6 m and plug set for AS4.

ALT 4/4P. ALT 6/6P

PLUS

On 6 m. model ALT has double spring to counter balance movement and make it more fluent, without bumps.

Anti-UV orange peel epoxy powder-coating.

Robust gears and levers for reliable functioning over time.

ELECTROMECHANICAL IRREVERSIBLE BARRIER FOR BAR FROM 4 TO 6 m, 24 Vdc and 230 Vac



CODE	DESCRIPTION	PCS PALLET
BR4	230 Vac motor, with control unit in box. Connector for receiver. For 4 m long barrier.	6
BR4-24	24 Vdc motor, with control unit in box and encoder. Connector for receiver. For 4 m long barrier.	6
BR4-24P	24 Vdc motor, with control unit in box and encoder. Connector for receiver. For 4 m long barrier. Fast version.	6
BR-624	230 Vac motor, with control unit in box and encoder. Connector for receiver. For 6 m long barrier.	6
BR-624P	24 Vdc motor, with control unit in box and encoder. Connector for receiver. For 6 m long barrier. Fast version.	6

NEW Application of new, 24 Vdc CT-724S control unit.

Performance increase: 3.5 sec opening time for 4m barrier and 6 sec for 6 m barrier (BR4-24P - BR-624P).

Encoder for the obstacle detection and immediate run inversion.

Linear acceleration and deceleration to make opening and closing run as smooth as possible.

For an intensive use, for private and public solutions.

Energy saving modality in standby.

Possibility to extract the control unit and program it in standing position for installer comfort and easy access.

Universal box: fast and easy installation of right or left bar depending on installation need.

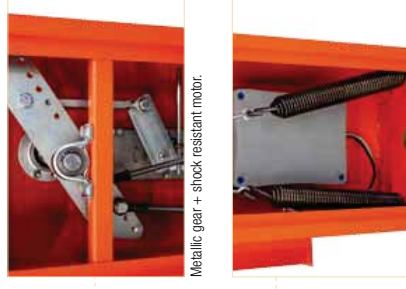
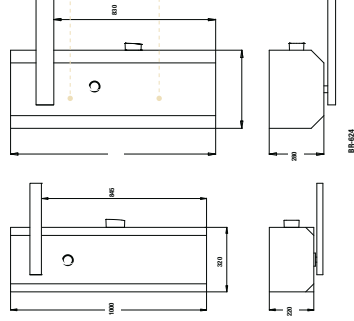

Metallic gear + shock resistant motor.

Double balanced springs for a more fluid movement.

ACCESSORIES ALT 4



CP-BR
Anchorage plate with rag bolts.



AS4
Aluminum bar
L=4000 mm
di. 60x30 mm.



AS-4J
2+2 m aluminum bar.
60x30x2 with joint included.



AST4
Aluminum tubular bar
L=4000 mm Ø 60 mm,
in case of strong wind.



ATAST60
Connection for round bar
Ø 60 mm.



AS-SNO3
Joint for articulated rods with
3 m aluminum bar included
(only for ALT 4 and ALT 4P).



PROF
Flexible rubber profile.
6 m and plug set for AS4.

ACCESSORIES ALT 6



CP-BR6
Anchorage plate with rag bolts.



AS6
Aluminum bar
L=6000 mm
di. 100 x 40 mm.



AS-6J
3+3 m aluminum bar.
100x40x2 with joint included.



AST6
Aluminum tubular bar
L=6000 mm Ø 90 mm,
in case of strong wind.



ATAST90
Connection for round bar
Ø 90 mm.



PROF6
Flexible rubber profile,
12 m and plug set for AS6.

TECHNICAL DATA		BR4	BR4-24 / BR4-24P	BR-624 / BR-624P
control unit		CT-101	CT24SBA / CT-724S	CT24SBA / CT-724S
power	Vac (Vdc)	230	(24)	(24)
consumption power	W	155	150	150
motor rpm	rpm	1400	1200	1200
motor consumption	A	0.67	6	6
capacitor	µF	8	-	-
opening time	sec	4,5	5 / 3,5	10 / 6
max bar length	m	4	4	6
working cycle	%	60	80	80
working temperature	°C	-20° + 55°	-20° + 55°	-20° + 55°
weight	kg	35	35	43
protection degree	IP	54	54	54

ALT 4KP / 6KP / 4 / 4P / 6 / 6P COMMON ACCESSORIES

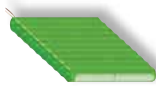

KBPKN
Kit 24 Vdc batteries,
1.300 mAh and battery charger.



BAT-12-2A
Battery 12 V 2 A.



CABAT-30
Battery charger
for 24 V detectors
(for CT-124SBA).

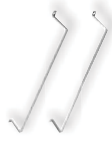

KITFIXBATT
Kit fixing batteries 24 V
(2 PCS).



KLIGHT
Kit lights (4 pcs).



AD
Red reflecting adhesive
strips (10 pcs).



CT-LIGHT
Control unit for **KLIGHT**.



TS
Warning board.



ALTPKM
Manual parking
space bar guard.



SKIRT
Kit aluminium fence,
length 2 m.



RIMAE
Magnetic sensor,
one coil, two exit
(impulse and presence).



APF
Fixed supports.



APM
Mobile supports.



Slowdown and limit switch.

Reflecting stripe.

LED lights.

NEMKO certification.

REVERSIBLE ELECTROMECHANICAL RISING BOLLARD WITH GREASE GEAR MOTOR

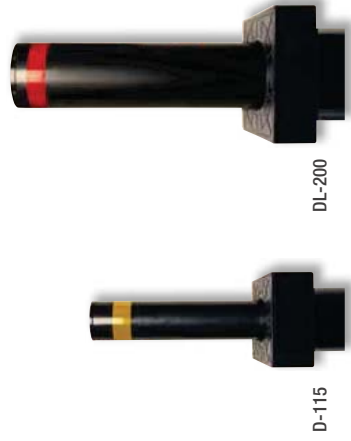

D-115

DL-200

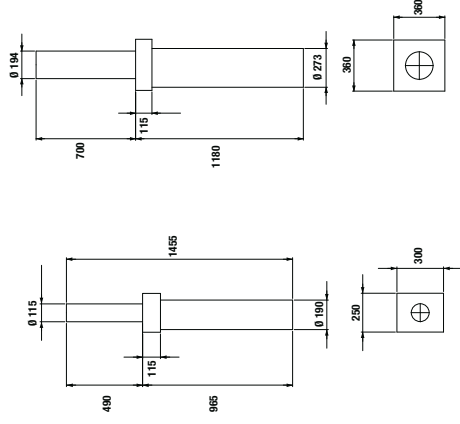

CODE	DESCRIPTION	PCS PALLET
D-115	230V ac electromechanical rising bollard. Opening time 6 sec. Height 500 mm, diam. 115 mm, depth 5,5 mm.	1
DL-200	230V ac electromechanical rising bollard. Opening time 6 sec. Including 24 Vac LED lighting kit. Height 700 mm, diam. 200 mm, depth 5,5 mm.	1

TECHNICAL DATA	D-115	DL-200
control unit	CT-D100*	CT-D100*
diameter	115	200
height above ground	500	700
material	ghisa	ghisa
thickness (bollard head)	5,5	5,5
break-through resistant	J	250.000
weight	65	80

* Suggested control unit.

ACCESSORIES



TWI

Tower totem to fit all electronic equipments, pre-set for circular installation of LED lights in the upper part.



SMFR

Traffic light with red-green light.



TWS

Upper totem for centralized technical control of urban accesses rising bollards. Pre-set for circular installation of led lights.



CT-D100

Control board for D-115 and DL-200.



TWL

Light system for TWI and TWS.



RIMAE

Magnetic sensor, one coil, two exit (impulse and presence).

KEY DOORS

Systems for rolling shutters



Sharp 60	70
Sharp 60BM	72
Sharp 76 - 76BM	74

Systems for industrial doors



Up	78
----	----

Systems for overhead and sectional doors



Blindo	84
Viper	86
Blindo Kit	88
Viper Kit	89

Automation for sliding doors



Wind Pro	92
Wind Light Pro	98
Wind Pro and Wind Light Pro accessories	104
Anti-panic systems	106
Fastening kit for glass door	106

keyindustry

SHARP
230 V_{ac}
ELECTROMECHANICAL
GEAR MOTOR
FOR ROLLING SHUTTERS

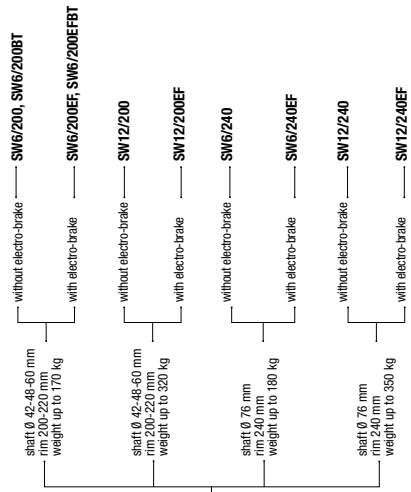

KEY Installations

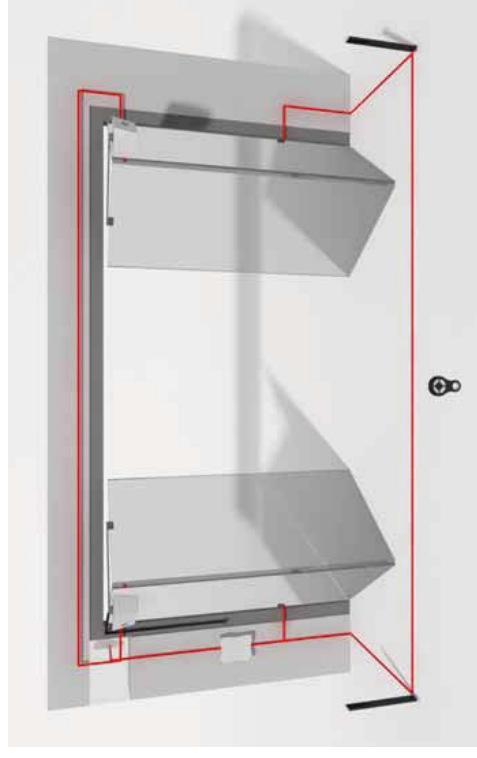

Semi-automatic limit switch, easy and intuitive.

Excellent performance thanks to noiseless adaptor.

ELECTROMECHANICAL GEAR MOTOR FOR ROLLING SHUTTERS, UP TO 170 Kg, 230 Vac

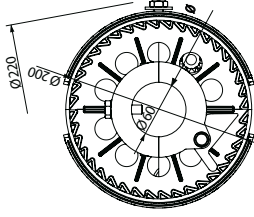
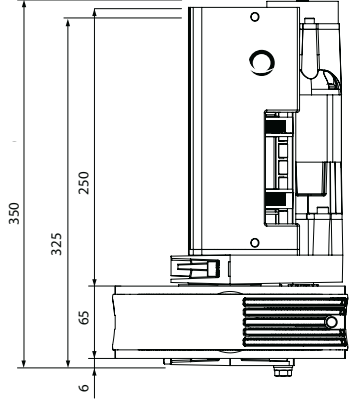

CODE	DESCRIPTION	PCS PALLET
SW6/200	Reversible motor for ø 42-48-60 mm shaft, rim ø 200-220 mm, 170 Kg.	30
SW6/200EF	Irreversible motor for ø 42-48-60 mm shaft, rim ø 200-220 mm, 170 Kg. With electro-brake.	30
SW6/200BT	Reversible motor for ø 42-48-60 mm shaft, rim ø 200-220 mm, 170 Kg. With limit switch circuit and low voltage activation.	30
SW6/200EFBT	Irreversible motor for ø 42-48-60 mm shaft, rim ø 200-220 mm, 170 Kg. With electro-brake, limit switch circuit and low voltage activation.	30

SW6/200
SW6/200EF

SW6/200BT
SW6/200EFBT

ACCESSORIES



SEL-M
Aluminium outdoor key selector.



BMET
External metallic box for motor release, including action button.



SW-EFE
Electro-brake with release.



TS
Warning board.



SUB-44WR
4 channels, water resistant transmitter 433.92 MHz, rolling code.



CT-1EBR
230 Vac control unit with integrated receiver, rolling code, in box.



LUMY-230
230 Vac flashing light, 25 W, with antenna.



FT-20K
Pair of photocells for external use and flush-mounting.

TECHNICAL DATA

SW6/200 - SW6/200EF
SW6/200BT - SW6/200EFBT

control unit CT-1EBR

power Vac 230

motor consumption W 600

strength A 2,8

torque Nm 175

speed rpm 10

working temperature °C -20° + 55°

max gear stroke m 6

thermo protection °C 170°

capacitor µF 18

weight kg 9 - 10

Semi-automatic limit switch, easy and intuitive.

Excellent performance thanks to noiseless adaptor.

Bi-motor version.

ELECTROMECHANICAL GEAR MOTOR FOR ROLLING SHUTTERS, UP TO 320 Kg, 230 Vac

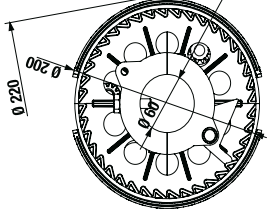
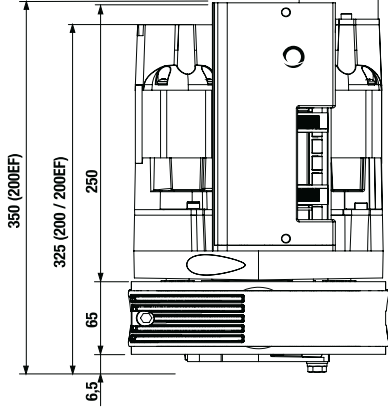

SW12/200
SW12/200EF

CODE	DESCRIPTION	PCS PALLET
SW12/200	Reversible bi-motor for ø 42-48-60 mm shaft, rim ø 200-220 mm, 320 Kg.	30
SW12/200EF	Irreversible bi-motor for ø 42-48-60 mm shaft, rim ø 200-220 mm, 320 Kg. With electro-brake.	30

TECHNICAL DATA

SW12/200 - SW12/200EF	
control unit	CT-1EB / CT-1EBR
power	Vac 230
motor consumption	W 1200
strength	A 5,6
torque	Nm 325
speed	rpm 10
working temperature	°C -20° + 55°
max gear stroke	m 6
thermoprotection	°C 170°
capacitor	µF 35
weight	kg 13,5 - 14,5

ACCESSORIES



SEL-M
Aluminium outdoor key selector.



BMET
External metallic box for motor release, including action button.



SW-EFE
Electro-brake with release.



TS
Warning board.



SUB-44WR
4 channels, water resistant transmitter 433.92 MHz.



CT-1EBR
230 Vac control unit with integrated receiver, rolling code. In box.



LUMY-230
230 Vac flashing light, 25 W, with antenna.



FT-20K
Pair of photocells for external use and flush-mounting.

SHARP 76 76BM PLUS

Semi-automatic limit switch, easy and intuitive.

Excellent performance thanks to noiseless adaptor.

76 mm shaft, single (SW6) or bi-motor (SW12) version.

ELECTROMECHANICAL GEAR MOTOR FOR ROLLING SHUTTERS, UP TO 350 Kg, 230 Vac



SW12/240
SW12/240EF

SW6/240
SW6/240EF

CODE	DESCRIPTION	PCS PALLET
SW6/240	Reversible motor for ø 76 mm shaft, rim ø 240 mm, 180 Kg.	30
SW6/240EF	Irreversible motor for ø 76 mm shaft, rim ø 240 mm, 170 Kg. With electro-brake.	30
SW12/240	Reversible bi-motor for ø 76 mm shaft, rim ø 240 mm, 350 Kg.	30
SW12/240EF	Irreversible bi-motor for ø 76 mm shaft, rim ø 240 mm, 350 Kg. With electro-brake.	30

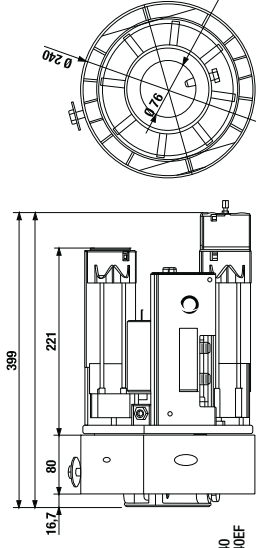

SW12/240
SW12/240EF

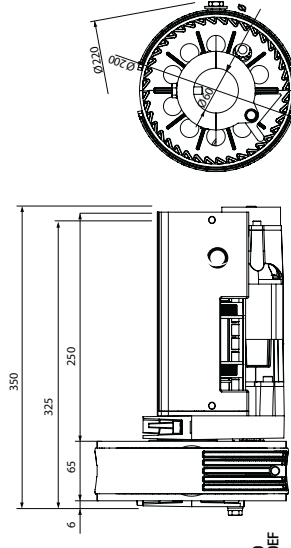

SW6/240
SW6/240EF

ACCESSORIES



SEL-M
Aluminium outdoor key selector.



BMET
External metallic box for motor release, including action button.



SW-EFE
Electro-brake with release.



TS
Warning board.



SUB-44WR
4 channels, water resistant transmitter 433.92 MHz, rolling code.



CT-1EBR
230 Vac control unit with integrated receiver, rolling code. In box.



LUMY-230
230 Vac flashing light, 25 W, with antenna.



FT-20K
Pair of photocells for external use and flush-mounting.

TECHNICAL DATA	SW6/240		SW6/240EF		SW12/240		SW12/240EF	
	CT-1EB/ CT-1EBR	CT-1EB/ CT-1EBR	CT-1EB/ CT-1EBR	CT-1EB/ CT-1EBR	CT-1EB/ CT-1EBR	CT-1EB/ CT-1EBR	CT-1EB/ CT-1EBR	CT-1EB/ CT-1EBR
power	Vac	230	230	230	230	230	230	230
motor consumption	W	600	600	1200	1200	1200	1200	1200
strength	A	2,8	2,8	5,6	5,6	5,6	5,6	5,6
torque	Nm	185	185	370	370	370	370	370
speed	rpm	8	8	8	8	8	8	8
working temperature	°C	-20° + 55°	-20° + 55°	-20° + 55°	-20° + 55°	-20° + 55°	-20° + 55°	-20° + 55°
max gear stroke	m	6	6	6	6	6	6	6
thermo protection	°C	170°	170°	170°	170°	170°	170°	170°
capacitor	µF	18	18	35	35	35	35	35
weight	kg	12	13	16,5	16,5	17,5	17,5	17,5

SYSTEMS FOR INDUSTRIAL DOORS

User manual

keyindustry

UP
ELECTROMECHANICAL
REVERSIBLE GEAR MOTOR
WITH STRAIGHT TELESCOPIC
ARM FOR FOLDING
SWING DOORS

normal use — SN-50B

intensive use — SN-50-24B



ELECTROMECHANICAL IRREVERSIBLE GEAR MOTOR WITH STRAIGHT TELESCOPIC ARM FOR FOLDING SWING DOORS, 24 Vdc AND 230 Vac

PLUS

With encoder in 24 Vdc version: speed and slowdown regulation possibility.

Maximum safety in the obstacle detection.

External release for an easy manual unlock from outside.

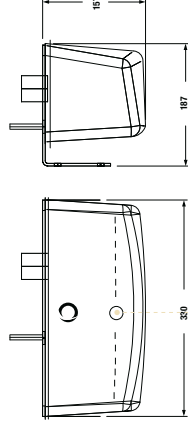

External release for an easy manual unlock from outside.



Battery back-up possibility inside control unit box.



Sturdy and robust arm for wide angles opening.

CODE	DESCRIPTION	PCS PALLET
SN-50B	230 Vdc motor, with opening and closing limit switch. Telescopic arm included.	36
 SN-50-24B	24 Vdc motor, with encoder. Telescopic arm included.	36

TECHNICAL DATA

control unit	SN-50B	SN-50-24B
	CT201 / CT2*	CTB24S*
power	Vac (Vdc)	(24)
consumption power	W	340
torque	Nm	350
motor consumption	A	6
capacitor	µF	-
protection degree	IP	43
working temperature	°C	-20° + 55°
max leaf length	m	1,5+1,5
weight	kg	13,8

* Suggested control unit.

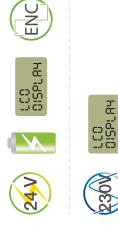

ACCESSORIES



SBCLB

Distance manual unlocking
L = 6000 mm.



BMET

External metallic box
for motor release complete
with start button.



KITFIXBATT

Kit fixing batteries 24 V.



BAT-12-2A

Battery 12 V 2 A.



TS

Warning board.

keyhome

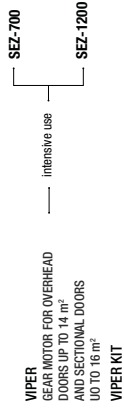
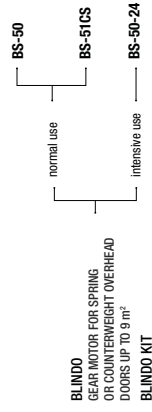

KEY Installations

BLINDO



VIPER

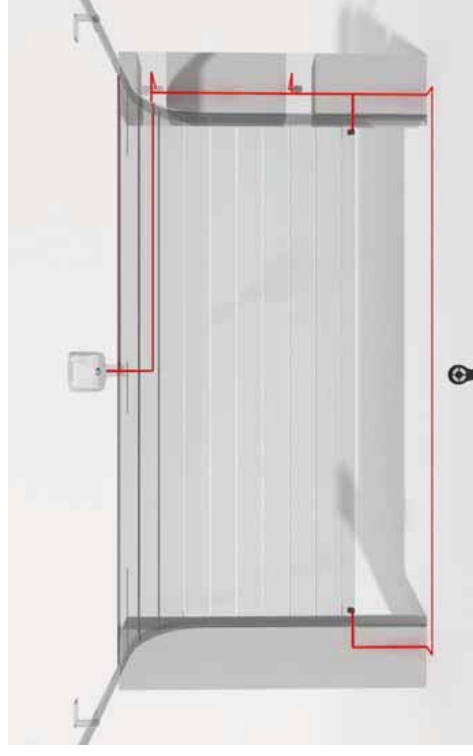

230 Vac motor, with pre-installed opening and closing limit switch.

24 Vdc motor with encoder provides big safety in the obstacle detection.

External release for an easy manual unlock from outside.

With slowdown, soft start and soft stop granting doors integrity.

ELECTROMECHANICAL IRREVERSIBLE GEAR MOTOR FOR SPRING OR COUNTERWEIGHT OVERHEAD DOORS UP TO 9 sqm, 24 Vdc AND 230 Vac

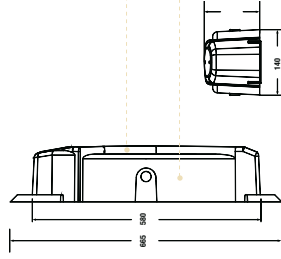

High precision limit switch.



Completely metallic gears.

ACCESSORIES

CODE	DESCRIPTION	PCS PALLET
BS-50	230 Vac motor, without control unit, with opening and closing limit switch. With internal release system and pre set for unlocking from outside.	40
BS-51CS	230 Vac motor, with control unit and slowdown, with opening and closing limit switch. With internal release system and pre set for unlocking from outside. With connectors for receiver.	40
BS-50-24	24 Vdc motor, with control unit, with encoder and slowdown. With release system and pre set for unlocking from outside. With connectors for receiver.	40



TECHNICAL DATA	BS-50		BS-51CS		BS-50-24	
		CF-101		CF-24SU		
control unit	-	-	-	-	-	-
power	Vac (Vdc)	230	230	230	(24)	(24)
consumption power	W	340	340	340	150	150
motor consumption	A	1,5	1,5	6	6	6
capacitor	µF	12,5	12,5	-	-	-
protection degree	IP	43	43	43	43	43
speed	cm/s	76	76	80	80	80
torque	Nm	350	350	350	350	350
max x door size	m²	9	9	9	9	9
insulation class		1	1	1	1	1
working cycle	%	30	30	80	80	80
working temperature	°C	-20° + 55°	-20° + 55°	-20° + 55°	-20° + 55°	-20° + 55°
weight	kg	14	14	14	13,8	13,8

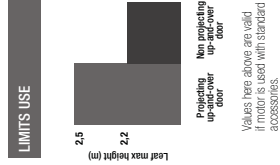

	BD (1 PC) Straight telescopic arm.		BDNS (1 PC) Straight telescopic arm with drilller round bar to avoid welding pipes.
	BC (1 PC) Standard curved telescopic arm.		BCBDC (2 PC) Curved telescopic arm with welded bushing.
	BCNS (2 PCS) Curved telescopic arm with drilller round bar to avoid welding pipes.		ST-650 Motor support bracket L=650 mm.
	ST-1600 (1 PC) Motor support bracket L=1600 mm.		ST-1800 (1 PC) Motor support bracket L=1800 mm.
	TZ-1500 (2 PC) 1500 mm long drive shaft, complete with supports.		TZ-2000 (2 PCS) 2000 mm long drive shaft, complete with supports.
	BOC (1 PC) Bushing.		SBLST Kit for unlocking with key ratchet and metal cord.
	SBCO External unlocking system (to be applied on handle lock) L=3000 mm.		TS Warning board.
	CABAT-30 Battery charger for 24 Vdc motors (for CF-24SBA).		BAT-12 Battery 12V, 1,2 A (for CF-24SBA).

24Vdc motor to offer full safety for residential use.

With encoder, control unit and 1 channel receiver included.



Possibility to select fix or rolling code.

One or three pcs pre-assembled guide, comprehensive of joint with chain option.

Adjustable motor head.

ELECTROMECHANICAL IRREVERSIBLE GEAR MOTOR FOR OVERHEAD DOORS UP TO 14 sqm AND SECTIONAL UP TO 16 sqm



CODE	DESCRIPTION	PCS PALLET
 SEZ-700	For overhead and sectional doors up to 10 sqm. 24 Vdc motor with control unit, one channel receiver and encoder, 700 N. With possibility of selecting fix or rolling code.	36
 SEZ-1200	For overhead doors up to 14 sqm and sectional doors up to 16 sqm. 24 Vdc motor with control unit, one channel receiver and encoder, 1200 N. With possibility of selecting fix or rolling code.	36
GU320	Pre assembled 3320 mm slide, complete with joint and chain.	-
GU3	Pre assembled 3320 mm slide, in 3 pcs, complete with joint and chain.	-
GU4000	Pre assembled 4000 mm slide, complete with joint and chain.	-

TECHNICAL DATA	SEZ-700		SEZ-1200	
	power	Vdc	24	24
consumption power	W	100	160	
motor consumption	A	4,16	6,66	
protection degree	IP	43	43	
strength	N	700	1200	
speed	cm/s	11	11	
stroke	m	2,8	2,8	
light	V/W	25 (1x) E14	25 (1x) E14	
max door size	m ²	10	16	
working cycle	%	60	60	
working temperature	°C	-20° + 55°	-20° + 55°	
weight	kg	10,5	11	

Data are subject to doors mechanical conditions (wear, spring counterbalance...) and guides typology.

LIMITS USE	
Basciulante disobstante	Basciulante adhesion adhesion adhesion
SEZ-700	
H = 2,5 m L = 4 m	H = 2,2 m L = 4,2 m
SEZ-1200	
H = 3,5 m L = 4 m	H = 3,2 m L = 3 m
	H = 3,2 m L = 5 m



Inner compact release carriage without protruding the guide volume.



Anti-intrusion function.

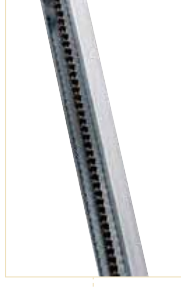

Safe and silent functioning thanks to chain transmission.

ACCESSORIES



KBPK

Battery 12V 1,2 A. and battery charger for 24 Vdc motor.

BO-SEZ

Swinging arm for counterweight overhead doors.

SBCO

External unlocking system (to be applied on handle lock) L=3000 mm.

SBLST

Kit for unlocking with key ratchet and metal cord.



TS

Warning board.

BLINDO KIT

FOR OVERHEAD DOORS UP TO 9 sqm

PLUS

230 Vac motor, with pre-installed opening and closing limit switch.

External release for an easy manual unlock from outside.

With slowdown, soft start and soft stop granting doors integrity.

NEW New water resistant SUB transmitter included.

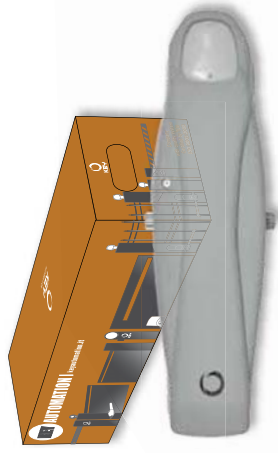

CODE	DESCRIPTION	PCS PALLET
KIT-BL51*	Kit for spring and counterweight overhead doors up to 9 sqm. 230 Vac motor, control unit with gradual departure and slowdown.	18+9

* Kit available also in the rolling code version: **KIT-BL51R**.

KIT COMPONENTS



BS-51CS



FT-31



ST-660



TZ-1500 (2 PCS)

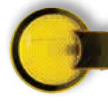

LUMY-230



SUB-44W



BDNS (2 PCS)



RXI-22

VIPER KIT

FOR OVERHEAD DOORS UP TO 14 sqm AND SECTIONAL DOORS UP TO 16 sqm

PLUS

24 Vdc motor to offer full safety for residential use.

With encoder, control unit and 1 channel receiver included.

Possibility to select fix or rolling code.

One or three pcs pre-assembled guide, comprehensive or joint with chain option.

Adjustable motor head.

NEW New water resistant SUB transmitter included.



CODE	DESCRIPTION	PCS PALLET
KSEZ700*	Kit for overhead and sectional doors up to 10 sqm. 24 Vdc motor, with chain movement and 3 pcs slide.	36
KSEZ1200*	Kit for sectional doors up to 16 sqm and spring or counterweight overhead doors up to 14 sqm. With chain movement and 3 pcs slide.	36

* Kit available also in the rolling code version: **KSEZ700R e KSEZ1200R**.

KIT COMPONENTS



SEZ-700
or
SEZ-1200
with
GU3



SUB-44W

keyindustry



- PA1901P
- PA2101P
- PA2501P
- PA2901P
- PA3301P
- PA3701P
- PA4201P

Assembled automation

PA151P

Custom made automation

WIND PRO
AUTOMATION FOR ONE SLIDING
DOOR 160 kg
AUTOMATION LENGTH
FROM 1900 TO 4200 mm

- PA1902P
- PA2102P
- PA2502P
- PA2902P
- PA3302P
- PA3702P
- PA4202P

Assembled automation

PA152P

Custom made automation

WIND PRO
AUTOMATION FOR TWO SLIDING
DOORS 130-130 Kg
AUTOMATION LENGTH
FROM 1900 TO 4200 mm

- PA1901LP
- PA2101LP
- PA2501LP
- PA2901LP
- PA3301LP
- PA3701LP
- PA4201LP

Assembled automation

PA151LP

Custom made automation

WIND LIGHT PRO
AUTOMATION FOR ONE SLIDING
DOOR 120 kg
AUTOMATION LENGTH
FROM 1900 TO 4200 mm

- PA1902LP
- PA2102LP
- PA2502LP
- PA2902LP
- PA3302LP
- PA3702LP
- PA4202LP

Assembled automation

PA152LP

Custom made automation

WIND LIGHT PRO
AUTOMATION FOR TWO SLIDING
DOORS 80-80 kg
AUTOMATION LENGTH
FROM 1900 TO 4200 mm



WIND PRO

PLUS

Self-bearing cover for an easier inspection from outside.

External digital key pad to program, select, set-up functions without operating on control unit.

Manual selector with knob for an easy standard functions selection.

Auxiliary connections operating status led.

NEW CT-PAE control unit.

Battery charge monitoring.

Safety device surveillance.

Setting speed improvement.

Automatic doors performance improvement.

AUTOMATION FOR SLIDING DOORS



CONTROL UNIT
The microprocessor control unit is equipped with connectors and terminals for the connection of:

Mains power

Motor power

Cyclic counter

Battery

Electromechanical stop

Function selector

TECHNICAL DATA

power supply	230V 50/60 Hz
consumption max	150 W
accessories power	24 Vdc
battery charger	charge voltage 27.5 Vdc; I max 200 mA with control in voltage
electric motor	24 Vdc maximum power 100 W
opening speed	adjustable max 70 cm/s (for leaf)
closing speed	adjustable max 60 cm/s (for leaf)
anti-crushing device	standard
opening pause time	adjustable from 0 to 60 sec.
operating temperature	-20° + 55°
transmission type	toothed belt
protection degree	IP 22
max weight one leaf	160 Kg
max weight two leaves	130 Kg + 130 Kg
use	intensive

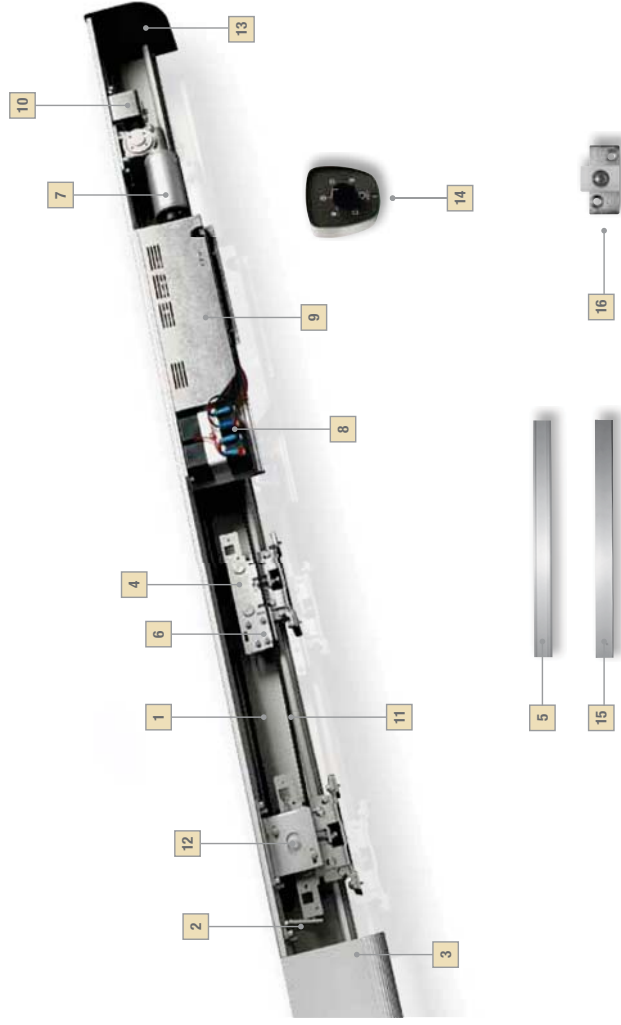

PART IDENTIFICATION

- 1. 10 MICRON CHEMICAL SILVER OXIDIZED ALUMINIUM BAR AND 500 mm STEP CAPACITY
- 2. MECHANICAL STOP
- 3. OXIDIZED ALUMINIUM BOX
- 4. CARRIAGE
- 5. ADAPTOR
- 6. TRACTION BRACKETS
- 7. DUNKER MOTOR WITH ENCODER
- 8. EMERGENCY BATTERY UNIT
- 9. CONTROL UNIT
- 10. ELECTROMECHANICAL STOP
- 11. BELT
- 12. TRANSMISSION PULLEY
- 13. BOX SIDE PLUG
- 14. DIGITAL SELECTOR WITH MICROPROCESSOR
- 15. FLOOR GUIDANCE
- 16. PLATE WITH HINGE AND NYLON BLOCK

WIND PRO AUTOMATION

Key Doors are a new series of straight sliding hi-tech automatic systems for very intensive use, with high technical content and silent operation, characterized by a classy design. They offer many features mixed with quality and reliability and are easy to install and program. The traction unit and the electronic control panel in one unit reduce the assembly time. Moreover Key Doors offers solutions with appropriate anti-panic break-out devices allowing easy access to escape routes. The complete range offers solutions for all requirements of size, use and weight.

TECHNICAL FEATURES

Key Doors are provided with a 24 Vdc motor, a microprocessor electronic control panel and an electronic impact-free device with encoder. Control unit, learn door weight and stroke length with a simple self learning procedure. The casing is made of aluminium extrusion and, thanks to a special locating hook system, there is the possibility to "hold open" the profile cover without supporting it. Faults are displayed on the selector screen.

AUTOMATION FOR SINGLE LEAF SLIDING DOOR UP TO 160 Kg

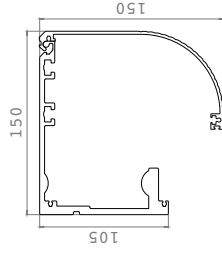

ASSEMBLED AUTOMATION INCLUDES:

CODE	DESCRIPTION
PA151P	Kit for single leaf.
PA000	Anodized beam profile.
PA001	Anodized cover profile.
PA003	Belt.
SMMPAE	Manual selector for automatic sliding gates.
PA020	Upper adaptor profile.
PA021	Floor guidance and track.
PA024	Plate with hinge and nylon block (1 pc).
PA032	Emergency battery kit 12 V - 1,2Ah with fixing aluminum support.
PA023	Electric lock kit set-up for installation with cord release PA011.

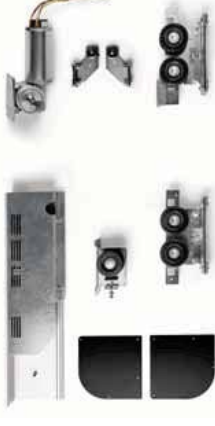

ASSEMBLED AUTOMATION AVAILABLE SIZES

CODE	NOMINAL CLEARANCE ROOM: mm	AUTOMATION LENGTH: mm
PA1901P	900	1900
PA2101P	1000	2100
PA2501P	1200	2500
PA2901P	1400	2900
PA3301P	1600	3300
PA3701P	1800	3700
PA4201P	2000	4200

For intermediate size select higher dimension.

PA151P / CUSTOM MADE AUTOMATION

KIT FOR SINGLE LEAF INCLUDES:

- Motor with encoder 24 Vdc (1 pc)
- Kit door carriages (1 pc)
- Electronic control unit (1 pc)
- Plug set (2 pcs)
- Manual selector (1 pc)
- Mechanic limit switch (2 pcs)
- Kit accessories and screws for fixing (1 pc)

NEW



OPTIONAL ELEMENTS

CODE	DESCRIPTION
PA000	Anodized beam profile.
PA001	Anodized cover profile.
PA003	Belt.
PA020	Upper adaptor profile.
PA021	Floor guidance and track.
PA024	Plate with hinge and nylon block (1 pc).
PA032	Emergency battery kit 12 V - 1,2Ah with fixing aluminum support.
PA023	Electric lock kit set-up for installation with cord release PA011.



For accessories go to page 94 and 95.

AUTOMATION FOR DOUBLE LEAF SLIDING DOOR UP TO 130+130 Kg

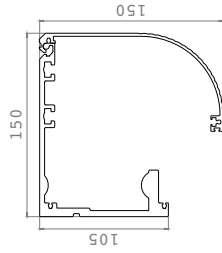

ASSEMBLED AUTOMATION INCLUDES:

CODE	DESCRIPTION
PA152P	Kit for double leaf.
PA000	Anodized beam profile.
PA001	Anodized cover profile.
PA003	Belt.
SMNPAE	Manual selector for automatic sliding gates.
PA020	Upper adaptor profile.
PA021	Floor guidance and track.
PA024	Plate with hinge and nylon block (2 pcs).
PA032	Emergency battery kit 12 V - 1,2A with fixing aluminum support.
PA023	Electric lock kit set-up for installation with cord release PA011.

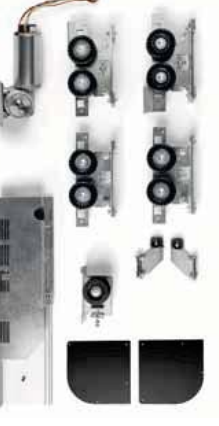

ASSEMBLED AUTOMATION AVAILABLE SIZES

CODE	NOMINAL CLEARANCE ROOM: mm	AUTOMATION LENGTH: mm
PA1902P	450 + 450	1900
PA2102P	500 + 500	2100
PA2502P	600 + 600	2500
PA2902P	700 + 700	2900
PA3302P	800 + 800	3300
PA3702P	900 + 900	3700
PA4202P	1000 + 1000	4200

For intermediate size select higher dimension.

PA152P / CUSTOM MADE AUTOMATION

KIT FOR DOUBLE LEAF INCLUDES:

- Motor with encoder 24 Vdc (1 pc)
- Kit door carriages (2 pcs)
- Electronic control unit (1 pz)
- Plug set (2 pz)
- Manual selector (1 pz)
- Mechanic limit switch (2 pz)
- Kit accessories and screws for fixing (1 pz)



OPTIONAL ELEMENTS

CODE	DESCRIPTION
PA000	Anodized beam profile.
PA001	Anodized cover profile.
PA003	Belt.
PA020	Upper adaptor profile.
PA021	Floor guidance and track.
PA024	Plate with hinge and nylon block (2 pcs).
PA032	Emergency battery kit 12 V - 1,2A with fixing aluminum support.
PA023	Electric lock kit set-up for installation with cord release PA011.

For accessories go to page 94 and 95.



WIND LIGHT PRO PLUS

PLUS

Self-bearing cover for an easier inspection from outside.

External digital key pad to program, select, set-up functions without operating on control unit.

Manual selector with knob for an easy standard functions selection.

Auxiliary connections.

Operating status led.

CT-PAE control unit.

Battery charge monitoring.

Safety device surveillance.

Setting speed improvement.

Automatic doors performances increasing.

AUTOMATION FOR SLIDING DOORS



CONTROL UNIT
The microprocessor control unit is equipped with connectors and terminals for the connection of:

- Mains power
- Motor power
- Cyclic counter
- Battery
- Electromechanical stop
- Function selector

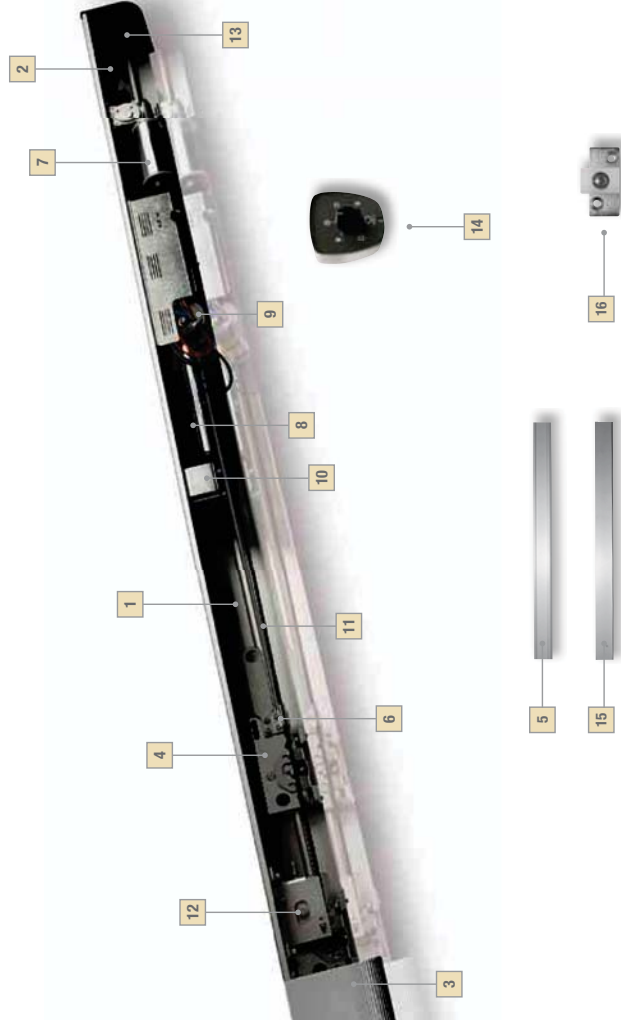

PART IDENTIFICATION

- 1. 10 MICRON CHEMICAL SILVER OXIDIZED ALUMINIUM BAR AND 500 mm STEP CAPACITY
- 2. MECHANICAL STOP
- 3. OXIDIZED ALUMINIUM BOX
- 4. CARRIAGE
- 5. ADAPTOR
- 6. TRACTION BRACKETS
- 7. DUNKER MOTOR WITH ENCODER
- 8. EMERGENCY BATTERY UNIT
- 9. CONTROL UNIT
- 10. ELECTROMECHANICAL STOP
- 11. BELT
- 12. TRANSMISSION PULLEY
- 13. BOX SIDE PLUG
- 14. DIGITAL SELECTOR WITH MICROPROCESSOR
- 15. FLOOR GUIDANCE
- 16. PLATE WITH HINGE AND NYLON BLOCK

WIND LIGHT PRO AUTOMATION

Key Doors are a new series of straight sliding hi-tech automatic systems for very intensive use, with high technical content and silent operation, characterized by a classy design. They offer many features mixed with quality and reliability and are easy to install and program. The traction unit and the electronic control panel in one unit reduce the assembly time. Moreover Key Doors offers solutions with appropriate anti-panic break-out devices allowing easy access to escape routes. The complete range offers solutions for all requirements of size, use and weight.

TECHNICAL FEATURES

Key Doors are provided with a 24 Vdc motor, a microprocessor electronic control panel and an electronic impact-free device with encoder. Control unit, learn door weight and stroke length with a simple self learning procedure. The casing is made of aluminium extrusion and, thanks to a special locating hook system, there is the possibility to "hold open" the profile cover without supporting it. Faults are displayed on the selector screen.

TECHNICAL DATA

power supply	230V 50/60 Hz
consumption max	80 W
accessories power	24 Vdc
battery charger	charge voltage 27.5Vdc; I max 200 mA with control in voltage
electric motor	24 Vdc maximum power 100 W
opening speed	adjustable max 70 cm/s (for leaf)
closing speed	adjustable max 60 cm/s (for leaf)
anti-crushing device	standard
opening pause time	adjustable from 0 to 60 sec.
operating temperature	-20° + 55°
transmission type	toothed belt
protection degree	IP 22
max weight one leaf	120 Kg
max weight two leaves	80 Kg + 80 Kg
use	intensive

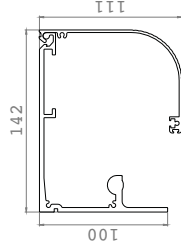

ASSEMBLED AUTOMATION INCLUDES:

CODE	DESCRIPTION
PA151LP	Kit for single leaf.
PA000L	Anodized beam profile.
PA001L	Anodized cover profile.
PA003	Belt.
SMMPAE	Manual selector for automatic sliding gates.
PA020	Upper adaptor profile.
PA021	Floor guidance and track.
PA024	Plate with hinge and nylon block.
PA022L	Emergency battery kit 12V - 1,2A with fixing aluminum support.
PA023L	Electric lock kit set-up for installation with cord release PA011.



ASSEMBLED AUTOMATION AVAILABLE SIZES

CODE	NOMINAL CLEARANCE ROOM: mm	AUTOMATION LENGTH: mm
PA150LP	900	1900
PA210LP	1000	2100
PA250LP	1200	2500
PA290LP	1400	2900
PA330LP	1600	3300
PA370LP	1800	3700
PA420LP	2000	4200

For intermediate size select higher dimension.

100

PA151LP / CUSTOM MADE AUTOMATION

KIT FOR SINGLE LEAF INCLUDES:

- Motor with encoder 24 Vdc (1 pc)
- Kit door carriages (1 pc)
- Electronic control unit (1 pc)
- Plug set (2 pcs)
- Manual selector (1 pc)
- Mechanic limit switch (2 pcs)
- Kit accessories and screws for fixing (1 pc)

NEW



OPTIONAL ELEMENTS

CODE	DESCRIPTION
PA000L	Anodized beam profile.
PA001L	Anodized cover profile.
PA003	Belt.
PA020	Upper adaptor profile.
PA021	Floor guidance and track.
PA024	Plate with hinge and nylon block.
PA022L	Emergency battery kit 12V - 1,2A with fixing aluminum support.
PA023L	Electric lock kit set-up for installation with cord release PA011.



For accessories go to page 94 and 95.

101

AUTOMATION FOR DOUBLE LEAF SLIDING DOOR UP TO 80+80 Kg

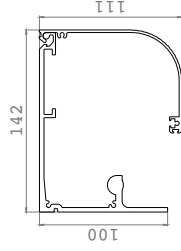

ASSEMBLED AUTOMATION INCLUDES:

CODE	DESCRIPTION
PA152LP	Kit for double leaf.
PA000L	Anodized beam profile.
PA001L	Anodized cover profile.
PA003	Belt.
SMNPAE	Manual selector for automatic sliding gates.
PA020	Upper adaptor profile.
PA021	Floor guidance and track.
PA024	Plate with hinge and nylon block.
PA022L	Emergency battery kit 12V - 1,2A with fixing aluminum support.
PA023L	Electric lock kit set-up for installation with cord release PA011.



ASSEMBLED AUTOMATION AVAILABLE SIZES

CODE	NOMINAL CLEARANCE ROOM: mm	AUTOMATION LENGTH: mm
PA1502LP	450 + 450	1900
PA2102LP	500 + 500	2100
PA2502LP	600 + 600	2500
PA2902LP	700 + 700	2900
PA3302LP	800 + 800	3300
PA3702LP	900 + 900	3700
PA4202LP	1000 + 1000	4200

For intermediate size select higher dimension.

PA152LP / CUSTOM MADE AUTOMATION

KIT FOR DOUBLE LEAF INCLUDES:

- Motor with encoder 24 Vdc (1 pc)
- Kit door carriages (2 pcs)
- Electronic control unit (1 pc)
- Plug set (2 pcs)
- Manual selector (1 pc)
- Mechanic limit switch (2 pcs)
- Kit accessories and screws for fixing (1 pc)

NEW



OPTIONAL ELEMENTS

CODE	DESCRIPTION
PA000L	Anodized beam profile.
PA001L	Anodized beam profile.
PA003	Belt.
PA020	Upper adaptor profile.
PA021	Floor guidance and track.
PA024	Plate with hinge and nylon block.
PA022L	Emergency battery kit 12V - 1,2A with fixing aluminum support.
PA023L	Electric lock kit set-up for installation with cord release PA011.



For accessories go to page 94 and 95.

WIND PRO AND WIND LIGHT PRO ACCESSORIES



SEL-M
Aluminum key switch.



SEL-T
Proximity sensor for transponder cards.



SEL-EU
Aluminum key switch with European cylinder.



SMNPAE
Manual selector for automatic sliding gates.



SEL-D
Aluminum wired digital key pad.



DECSEL-T
Decoder for proximity sensor for transponder cards **SEL-T**.



DECODER
Decoder for digital key pad **SEL-D**.



SEL-TXF
Radio controlled digital key pad in aluminum.



RXM-22
Universal radio 2 channels fix or rolling code.



PA012
Infra red volumetric radar.



PA025
Active infrared radar sensor.



**PA011
PA011L**
Complete kit for manual release.



BMET
External metal box for motor release including action button.



SPA125
Brush h. 25 mm for cover PA-PAL 1000 mm.



KPAFKO
Carter supports.



CARD
Transponder card (10 pcs).



KOMSCA
Kit cable supports PA-PAL (10 pcs).



PA014
Photocells kit with electronic board.



ADPPA
Adhesive automatic doors R + L (5 pcs).



TAG
Proximity tag with key ring.



SUB-44W
4 channels transmitter, 433.92 MHz, water resistant.

ANTI-PANIC SYSTEMS

CODE	DESCRIPTION	
KITANSF1	Full crash anti-panic system for one door max. length 1100 mm.	
PA033	Upper anti-panic adaptor profile.	
PA034	Lower anti-panic adaptor profile.	

FASTENING KIT FOR GLASS DOOR

CODE	DESCRIPTION	
PA005	Fastening kit for glass door 1500 mm.	

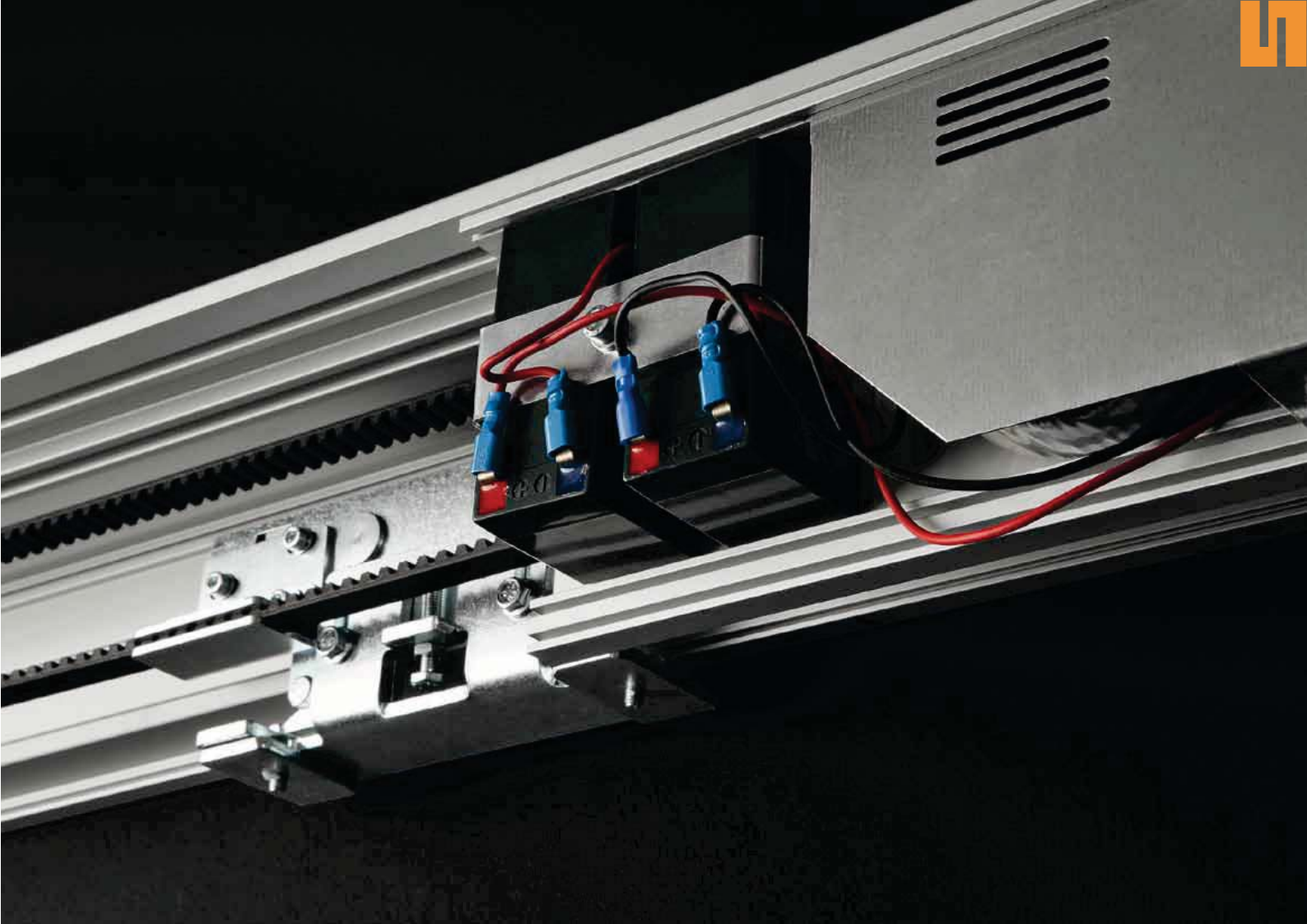

KEY Accessories

Control units and programmable functions

Go 24	110
Go 230	111
Go 380	112

Accessories

Sub	116
Memo	118
Orion	118
Memo Acces	119
Sekur FT	120
Sekur CH	121
Sekur C	122
Sekur D/T	123
Sekur CO/COR	124
Lumy	125

GO 24

230 Vac CONTROL UNITS

PLUS

- New generation control unit with LCD display.
- New generation control unit with soft start and soft stop function availability.
- Motor speed regulation and safety edge connection possibility.



CT-824S

PLUS

- Easy programming.
- Encoder for the obstacle detection (CT-101).
- New generation control unit with LCD display (CT-101 and CT-201).



CT-101



CT-201



CT-1EBR

NEW CT-724S, new self-programming control unit for 1 motor 24 Vdc.

- Provided with safety and LED command indication.
- Easy configuration with LCD display with 2 programming levels: basic and advanced one.
- Flashing light, courtesy light and gate open light exit can be set up separately.

Electronic protection to motor short-circuit, with rapid intervention.

Electronic protection to overcharge.

Overcharge protection.

Self diagnosis through flashing light and display.

New generation Ni-MH batteries as optional on board.

NEW CT-1EBR:

Possibility to do the self-learning process via radio, by following a pre-set sequence.

Limit switch control.

STOP safety control + photocell.

Flashing light exit and gate open light.

CODE	DESCRIPTION
CT-824S	For two motors, 24 Vdc switching with encoder, battery charger and connectors for receiver.
CT-724S	For one sliding,overhead motor or barrier 24 Vdc, with encoder.

TECHNICAL DATA		CT-824S	CT-724S
power	Vac / Hz	230 / 50	24 / 50
output accessories power	Vdc / mA	24 / 400	24 / 300
working time	sec	2-180	2-180
protection degree	IP	54	54
operating temperature	° C	-20° + 55°	-20° + 55°

GO 230

230 Vac CONTROL UNITS

CODE	DESCRIPTION
CT-101	For one sliding, overhead or barrier 230 Vac motor. With electric clutch and connectors for receiver, encoder and slowdown in opening and closing.
CT-2	For two swing 230 Vac motors, with logical control card, with connectors for receiver. In box.
CT-201	For two swing 230 Vac motors, with electric clutch option, connectors for receiver and slowdown. In box.
CT-1EBR	For one rolling shunter motor 230 Vac. With electric clutch and radio decoder. Rolling code. In box.

TECHNICAL DATA		CT-101	CT-2	CT-201	CT-1EBR
power	Vac / Hz	230 / 50	230 / 50	230 / 50	230 / 50
output accessories power	Vdc / mA	24 / 300	24 / 400	24 / 400	24 / 300
working time	sec	120	60	120	2-60
pause time	sec	120	2-180	120	-
protection degree	IP	54	54	54	56
operating temperature	° C	-20° + 55°	-20° + 55°	-20° + 55°	-20° + 55°

400 Vac CONTROL UNITS

GO 24/GO 230/GO 380 ACCESSORIES

GO
380

PLUS

For industrial motor.

With connectors for receiver.



CT-380
CT-380E

CT-381
CT-381E

CODE	DESCRIPTION
CT-380	For one sliding or industrial sectional doors 400 Vac / 230 Vac motor, with slowdown, brake system, connection for receiver. In box.
CT-381	For one sliding or industrial sectional doors 400 Vac / 230 Vac motor, with slowdown, brake system, connection for receiver. In box with control buttons.
CT-380E	For one sliding or industrial sectional doors 400 Vac / 230 Vac motor, with connection for receiver. In box.
CT-381E	For one sliding or industrial sectional doors 400 Vac / 230 Vac motor, with connection for receiver. In box with control buttons.

COMMON ACCESSORIES



RXI-22
2 channels plug-in receiver,
fix or rolling code.



RXM-22
2 channels universal receiver,
fix or rolling code. In box.

ACCESSORIES GO 24



BOXKEY
Plastic box for two motors
control unit.

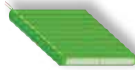

KBPKN
Kit 24 Vdc batteries,
1300 mAh and battery
charger, up to 500 kg.



KITFIXBATT
Kit fixing batteries 24 Vdc
for **BOXKEY** (2 PCS).

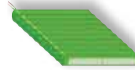

KBPKN2
Kit 24 Vdc batteries, 10
A, 1300 mAh and battery
charger, from 500 kg for
extreme performance.



BAT-12-2A
Battery 12 V 2 A.

ACCESSORIES GO 230



460T230V101B
Transformer for CT-101.



BOXKEYS
Plastic box for one motor
control unit.

TECHNICAL DATA

	CT-380 / CT-381 CT-380E / CT-381E
power motor	Vac / Hz 400-230 / 50
max motor load	W 2000
output accessories power	Vdc / W 24 / 15
working time	sec 0-120
pause time	sec 0-120
protection degree	IP 56
operating temperature	° C -20° + 55°

PROGRAMMABLE FUNCTIONS

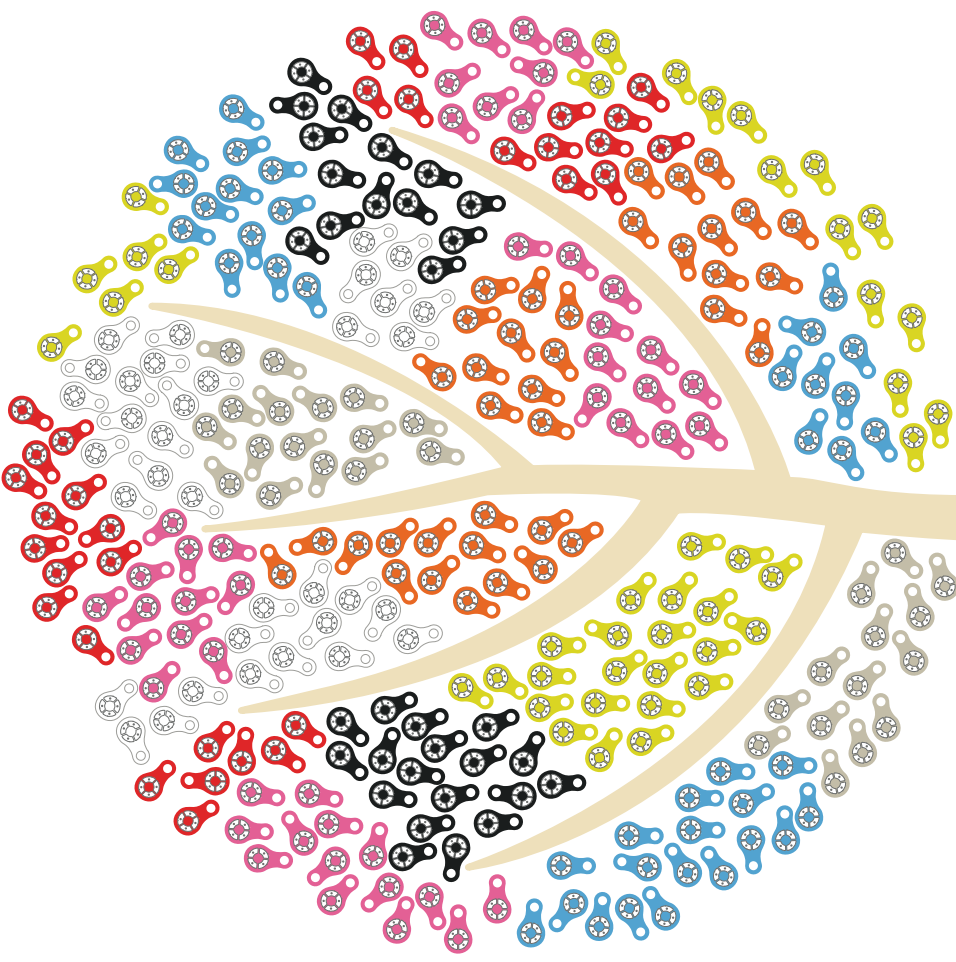

Welcome to Sub-land

Motor power	CT-24M	CT-SEZ	CT-724	CT-824S	CT-1ER	CT-101	CT-201	CT-2	CT-380	CT-381	CT-380E	CT-381E
	24 Vdc			230 Vac		380 Vac						
Motors n.	1	1	2	1	2	2	2	2	2	2	2	2
Hold to run												
Semi automatic functioning	•	•	•	•	•	•	•	•	•	•	•	•
Automatic functioning	•	•	•	•	•	•	•	•	•	•	•	•
Condominium function (only open)	•	•	•	•	•	•	•	•	•	•	•	•
Pre-flashing												
Photo during opening	•											
Soft start	•	•	•	•	•	•	•	•	•	•	•	•
Soft stop	•	•	•	•	•	•	•	•	•	•	•	•
Courtesy light	•	•	•	•	•	•	•	•	•	•	•	•
Open gate light with proportional flashing light	•								•	•	•	•
Slowdown function	•	•	•	•	•	•	•	•	•	•	•	•
Water hammering												
Electric limit switch exclusion												
Temporary pause in opening	•											•
Step by step function (open-stop-close-stop)	•	•	•	•	•	•	•	•	•	•	•	•
Separate open and close			•									
Working time extension												
Pause time with presence detector	•	•	•	•	•	•	•	•	•	•	•	•
1st motor delay during opening												
Brake												•
Cycles counter		•	•	•	•	•	•	•	•	•	•	•
Display		•	•	•	•	•	•	•	•	•	•	•
Encoder	•	•	•	•	•	•	•	•	•	•	•	•
Close after passage												•
Pedestrian opening	•	•	•	•	•	•	•	•	•	•	•	•
Electrolock												•
Stand by	•											
Black-out settings		•	•	•	•	•	•	•	•	•	•	•
Safety edge connection			•	•	•	•	•	•	•	•	•	•

PLUS

- Water resistant.
- Ergonomic, simple and modern design.
- Valuable materials and tidy details thanks to the new generation tri-injection molding process.
- Metal chromed insert.
- Different interchangeable colors.



Design: Francesca and Nicola

SUBFamily



CODE	DESCRIPTION
SUB-4AW	4 channels, fix code, 433,92 MHz transmitter. White color.
SUB-4AWR	4 channels, rolling code, 433,92 MHz transmitter. White color.
SUB-4AWN	4 channels, copier, 433,92 MHz transmitter. White color.
SUB-4AWRT	4 channels, rolling code, 433,92 MHz transmitter, with transponder. White color
SUB-4A	4 channels, fix code, 433,92 MHz transmitter. Black color.
SUB-4AR	4 channels, rolling code, 433,92 MHz transmitter. Black color.
SUB-4AN	4 channels, copier, 433,92 MHz transmitter. Black color.

CODE	DESCRIPTION
KCOSUBO	Kit 10 pcs orange cover for Sub (upper + lower)
KCOSUBB	Kit 10 pcs blue cover for Sub (upper + lower)
KCOSUBD	Kit 10 pcs gray cover for Sub (upper + lower)
KCOSUBM	Kit 10 pcs magenta cover for Sub (upper + lower)
KCOSUBR	Kit 10 pcs red cover for Sub (upper + lower)
KCOSUBG	Kit 10 pcs green cover for Sub (upper + lower)
KCOSUB	Kit 10 pcs black cover for Sub (upper + lower)



RXI-22

RXM-22
RXM-44RRXM-44
RXM-44R

RXM-230-42



MEM

CODE	DESCRIPTION
RXI-22	2 channels plug-in receiver, fix or rolling code, 400 codes.
RXM-22	2 channels universal receiver, fix or rolling code, 400 codes. In box.
RXM-44	4 channels universal receiver, fix code, 400 codes. In box.
RXM-44R	2 channels universal receiver, fix code, 220 codes. In box.
RXM-230-42	2 channels universal fix and rolling code receiver, 400 codes.
MEM	Memory for expanding codes up to 800 for RXI-22 and RXM-22.

TECHNICAL DATA		RXI-22 RXM-22	RXM-44 RXM-44R	RXM-230-42
reception frequency	MHz	433.920	433.920	433.920
power	Vac / Vdc	12 / (24)	12 / (24)	230
idle consumption	mA	12	12	16
sensitivity	dBm	-109	-109	-108
relay contacts max supply	A	1	1	8
relay contacts max voltage	Vdc	24	24	230
operating temperature	°C	-20° + 55°	-20° + 55°	-20° + 55°

ORION

2 CHANNELS TRANSMITTER 433 MHz



TXB-42



TXB-42R



TXB-42N

CODICE	DESCRIZIONE
TXB-42	2 channels fix code, 433.92 MHz.
TXB-42R	2 channels rolling code, 433.92 MHz.
TXB-42N	2 channels copier, 433.92 MHz.

MEMO

ACCES

PLUS

- 12/24 Vac/dc or via USB power.
- Communication software.
- 700 codes management.
- User data registration.
- Possibility to back-up on PC / memory support.
- Single code cancellation via PC.
- 4 relé exit with contacts on change NC/NO (1A/24V AC/DC).
- Relé exit scheduled function: Impulsive-Timer_BI-stable.
- Memory learning block.
- Password PIN setting.

SYSTEM FOR USERS CODES MANAGEMENT



RXM-440R



CDUSB

CODE	DESCRIPTION
CDUSB	CD-ROM for the installation of the program for users' code managing, USB cable and antenna.
RXM-440R	Receiver 4 channels, rolling code, programmable, 700 codes.

TECHNICAL DATA		RXM-440R
reception frequency	MHz	433.920
power	Vac/dc	12/24
idle consumption	mA	16
sensitivity	dBm	-108
relay contacts max supply	A	1
relay contacts max voltage	Vac/dc	24
operating temperature	°C	-20° + 55°



CODE	DESCRIPTION
FT-31	Pair of photocells for external use and flush mounting.
FT-20K	Pair of photocells for external use for small pillars (90x30x28 mm).
FT-40K	Pair of photocells for external use adjustable through 180°, for small pillars (90x30x28 mm).
FT-41	Pair of photocells for external use adjustable through 180°, for small pillars with battery kit.

FT-31 FT-20K FT-40K FT-41



CODE	DESCRIPTION
CH-51	Couple of support posts H 50 cm with anodized aluminum.
CH-101	Couple of support posts H 100 cm with anodized aluminum.
CH-50	Couple of support posts H 50 cm with aluminum.
CH-100	Couple of support posts H 100 cm with aluminum.

CH-51 CH-101 CH-100 CH-50

Accessories

TECHNICAL DATA

	FT-31 / FT-20K / FT-40K	FT-41
range	20	20
power	12 / (24)	12 / (24) rx - 3 tx
consumption rx	30	30
consumption tx	20	0,04
relay contacts max supply	A	1
relay contacts max voltage	Vdc	24
working temperature	°C	-20° + 55°

ACCESSORIES



MUR-P
Plastic wall support.



SUMCH
Support head for photocell and column digital key pad.



BAT-3
Kit battery for FT-41.





SEL-M



SEL-EU

CODE	DESCRIPTION
SEL-M	Aluminum key switch.
SEL-EU	Aluminum key switch with European cylinder.



SEL-D
SEL-TXF



SEL-T

CODE	DESCRIPTION
SEL-D	Wired digital key pad in aluminum, to be ordered together with DECODER .
SEL-TXF	Radio controlled digital key pad in aluminum, to be ordered together with all fix radio receiver.
SEL-T	Proximity sensor for transponder cards, to be ordered together with DECSEL-T .

ACCESSORIES



RXM-42

Two channels, fix code, universal receiver.



DECODER

Decoder for digital key pad **SEL-D**.



DECSEL-T

Decoder for proximity sensor for transponder cards **SEL-T**.



BATDIG

Batteries kit for **SEL-TXF**.



CARD

Transponder card (10PCS).



TAG

Proximity tag with key ring.



CODE	DESCRIPTION
COMS16	Mechanic safety edge, 1,6 m long for sliding gates. With micro-switches.
COMS20	Mechanic safety edge, 2,0 m long for sliding gates. With micro-switches.
COMS25	Mechanic safety edge, 2,5 m long for sliding gates. With micro-switches.
COMB12	Mechanic safety edge, 1,2 m long for overhead doors. With micro-switches.
COMB18	Mechanic safety edge, 1,8 m long for overhead doors. With micro-switches.
COMSR16	Mechanic safety edge, 1,6 m long for sliding gates. With continuous self diagnosis technology (8,2 KO).
COMSR20	Mechanic safety edge, 2,0 m long for sliding gates. With continuous self diagnosis technology (8,2 KO).
COMSR25	Mechanic safety edge, 2,5 m long for sliding gates. With continuous self diagnosis technology (8,2 KO).
COMBR12	Mechanic safety edge, 1,2 m long for overhead doors. With continuous self diagnosis technology (8,2 KO).
COMBR18	Mechanic safety edge, 1,8 m long for overhead doors. With continuous self diagnosis technology (8,2 KO).

Safety devices o be fitted on automatic closing systems. Control board and resistance.
With line **COMB** obligator. **ANGDX, ANGSX, TAPDX, TAPSX, GIUNX**.

ACCESSORIES



SKR
Electronic system checking the correct operation of one and more safety devices.



ANGSX
Left angle joint.



TAPSX
Left finishing cap.



ANGDX
Right angle joint.



TAPDX
Right finishing cap.



GIUN
Joins.



CODE	DESCRIPTION
LUMY24	24 Vdc flashing light, 25 W, with antenna.
LUMY230	230 Vac flashing light, 25 W, with antenna.

ACCESSORIES



ANTS-433
433 MHz, aerial with steel bracket and 5 mrg-58 cable.



ORG-58
Coaxial cable rg-58.



SULU
Support for LUMY.

1. EFFECTIVENESS OF THESE GENERAL CONDITIONS OF SALE

These general conditions of Sale will replace all previous conditions and are applicable to all orders submitted to Key Automation S.p.a. (hereinafter referred to as Key Automation) for products carrying the Key Automation trade mark. All sales of goods by Key Automation to its Customers (hereinafter referred to as Customer) shall be governed by the following General Conditions of Sale, which shall constitute an integral part of any agreement for the sale of goods between Key Automation and Customer, and shall supersede and cancel any inconsistent covenant or provision contained in the order or other document issued by the Customer. Illustrations and descriptions contained in Key Automation catalogues and other printed materials are for the sole purpose of identification, and may be modified by Key Automation at any time without prior notice.

2. ORDERS

Any orders shall be deemed as issued "subject to availability of the goods and any alteration of the price lists". Key Automation reserves the right to accept or reject, in whole or in part, any order submitted by the Customer, on account of their compliance with these General Conditions, and of the availability of the goods order. Key Automation reserves the right to change/modify the technical characteristics of its products at any time and without prior notice or liability. Orders placed by the customer cannot be cancelled by the Customer, either wholly or partially, after ten days of being submitted to Key Automation; if any orders are cancelled after such term, Key Automation shall be entitled to payment of the whole price.

3. PRICES

The goods shall be sold by Key Automation to Customer at the prices set out in the Key Automation price list effective at the time of delivery. The Customer shall unconditionally accept any variation of the price list made between the time of order and the time of delivery. Any new Key Automation price list cancels and substitutes the previous ones. All prices in the Key Automation catalogue are "ex factory" and before tax.

4. DELIVERY TERMS

All goods shall be delivered "ex factory" Key Automation S.p.a., via Volta 30 30020 Noventa di Piave (Venezia). Except for different written agreement, delivery terms are 10 days for National shipment and 30 days for international shipment; a part for products signed on price list with red sign on right part of paper, which have a delivery time of 6 weeks. Delivery terms start from customer acceptance of Key Automation order confirmation. In case of delay of delivery not exceed in customary allowances, the Customer shall not be entitled to claim for termination, in whole or in part, of the agreement, or to refuse to accept delivery of the goods, or to claim compensation for damages. The obligation to deliver the goods shall be fulfilled upon delivery of the goods to the carrier. Key Automation shall be released from the obligation to deliver the goods in any event of "Act of God" or "force majeure", such as strikes, social and political disorders, unavailability of raw materials, electrical components or other products, and any other events preventing Key Automation from delivering the goods, for which Key Automation is not responsible.

5. SHIPMENTS

The goods shall be shipped on such carrier(s) as Key Automation may select, and Key Automation shall charge the relevant amount to the Customer including in the relevant invoice. The customer may agree with Key Automation at the time of order, to use a different carrier, (always at the customer costs, or to collect the goods directly ex factory Key Automation S.p.A., Noventa di Piave, Venezia. All risks shall pass to the Customer at the time of delivery. Thefts, losses, damages, shortfalls shall not release the Customer from the obligation to pay the price, if the goods have been duly delivered to the carrier at Key Automation factory. The goods shall not be covered by insurance, unless expressly required by the Customer and at Customer's cost and risk.

6. COLLECTION OF THE GOODS

The Customer shall properly collect the goods as soon as they are put at the Customer's disposal, and communicated to him through telephone, fax or e-mail. In case of delay, Key Automation shall be entitled to full payment of the price and reimbursement for any cost of storage and custody of the goods, saving any compensation for damages. Key Automation shall not be liable in respect of any damage resulting directly or indirectly from the storage of any goods not collected when available at the Key Automation warehouses of the carrier, forwarding agent or third parties.

7. WARRANTY

Our guarantee takes effect from the date of manufacturing, put on each Key's product and it lasts for 30 months. This warranty period is fix and imperative. It is limited exclusively to the repair or replacement free of charge of the parts recognised by Key Automation as faulty due to lack of essential qualities in the material or to errors in workmanship. Any complaints about apparent defects shall be claimed to Key Automation compulsory no later than 8 days after delivery and occur defects within 8 days from discovery. If these terms are not respected the warranty is not valid. Complaints never allow the order reducing or cancellation from Customer, and moreover never allow Key Automation refund or compensation. All expenses related to delivery and dispatch of complained material are charged to the customer.

Key Automation shall not be responsible for any direct or consequential damage or injury caused by installation and use of any equipment. In the event of totally or partially irreparable equipment, Key Automation shall arrange for its replacement in the state in which it is or, upon explicit request of the customer, shall repair the same by replacing the irreparable parts, charging the customer with the whole cost of the new parts supplied. Key Automation shall not be held responsible for defects resulting from connection, combination, or interaction of its products with other products not supplied by Key Automation. Key Automation products can only be used in combination with other Key Automation's products, failing which this warranty will cease to be effective. Key Automation disclaims all liability for defects or damage resulting from failure to comply with its assembly and wiring instructions, or with any electrical codes or other regulations locally in force at the time of installation. Moreover the Manufacturer disclaims all responsibility for defects or damage resulting from improper installation, use or connection of any accessories and/or electrical or mechanic components manufactured by Key Automation, including failure to comply with the diagrams and types of connections for which these products have specifically been designed, as well as for the use or application of these products for purposes other than those for which they are intended, in compliance with their specific capacity and range. For products longer covered by this warranty Key Automation shall provide repair services, charging the related costs to the Customer. In case of products that cannot be repaired, Key Automation shall, at its sole discretion, replace them, and charge related costs to the Customer.

8. COMPLAINTS AND RETURNED GOODS

No complaints are accepted after 8 days from the receipt of the goods. Any return of goods for credit must be authorised before and by Key Automation. Goods returns and shipment freight are of customer charge. Any communication has to be done to Key Automation headquarter.

9. CANCELLATION CLAUSE

If the customer fails to pay the total price of goods or even a part of it by the previously agreed expiration date specified in the invoice, Key Automation will be entitled to cancel the right of goods receipt by the customer, cancel the sale and moreover charge the customer with interests on arrears in equal measure to standard norms and not inferior to current bank interests. Key Automation is also entitled to cancel the sale at any moment by simply forwarding a written notice of cancellation to the customer without the involvement of any juridical court. Goods that have been delivered to customers but not paid completely should be given back to Key Automation on customer's charge. In order to do so, Key Automation and any other entitled third party or carrier are authorized to demand and retrieve unpaid goods from customer's facility. It is not am any kind of compensation possibility between possible credits claimed by customer and its debts with Key Automation, except if agreed by Key Automation with formal written agreement between the parts.

10. TRADEMARKS AND DISTINCTIVE MARKS

The customer is aware of the fact that Key Automation products are subjected to both the know-how and design intellectual ownership right which is an exclusive industrial property of Key Automation. Customers shall not violate the rights of Key Automation by removing, covering or in any way changing trademarks, distinctive marks or labels and the like attached to products and shall not apply there on new trademarks, distinctive marks or labels and the like of any kind. Unless written authority is given by Key Automation to the contrary, any form of reproduction use by the Customer of the Key Automation trademark, logos, emblems, symbols and the like attached to or applied on the products is forbidden.

11. RETENTION OF TITLE

Notwithstanding any other provision contained herein, it is acknowledged and agreed that ownership of the goods shall pass to the Customer only upon full payment of the total price; therefore until full payment (including interest) is received by Key Automation, the goods delivered - wherever they may be held and even if they have already been resold by the Customer - shall remain the sole and exclusive property of Key Automation. Any cheques, bills of Exchange and transfer of credit will count as payment only upon collection. In the event of non - payment, Key Automation shall be entitled to immediate repossess sold products wherever they may be located. The Customer shall disclose the names of any third purchasers of the products, from whom Key Automation shall be entitled to claim and collect them

12. ITALIAN LAW AND COMPETENT COURT

The place of jurisdiction for any dispute that may rise in relation to the performance of the contract is the Law Court of Treviso (Italy).

13. VARIOUS

At the time of signing the contract or order confirmation, the Customer accepts these general terms. Any modification to the general terms must be signed by Key Automation S.p.A. and stipulated in written form. For sales made in foreign countries, Italian law will be applied. All information have been listed and carefully checked by Key Automation S.p.A., but the company decline any kind of responsibility for possible mistakes or omissions.

REV. 00 del 20/02/2012

Concept: Key Automation Spa
Impaginazione: www.giorgiathorlo.it
Stampa: Linea Grafica Srl



KEY AUTOMATION S.P.A.

Via Alessandro Volta, 30
30020 Noventa di Piave
VENEZIA - Italy
T. +39 0421 307456 - F. +39 0421 65698
info@keyautomation.it - www.keyautomation.it



Organizzazione con sistema di gestione certificato
ISO 9001:2008